

# Pemo / Remo

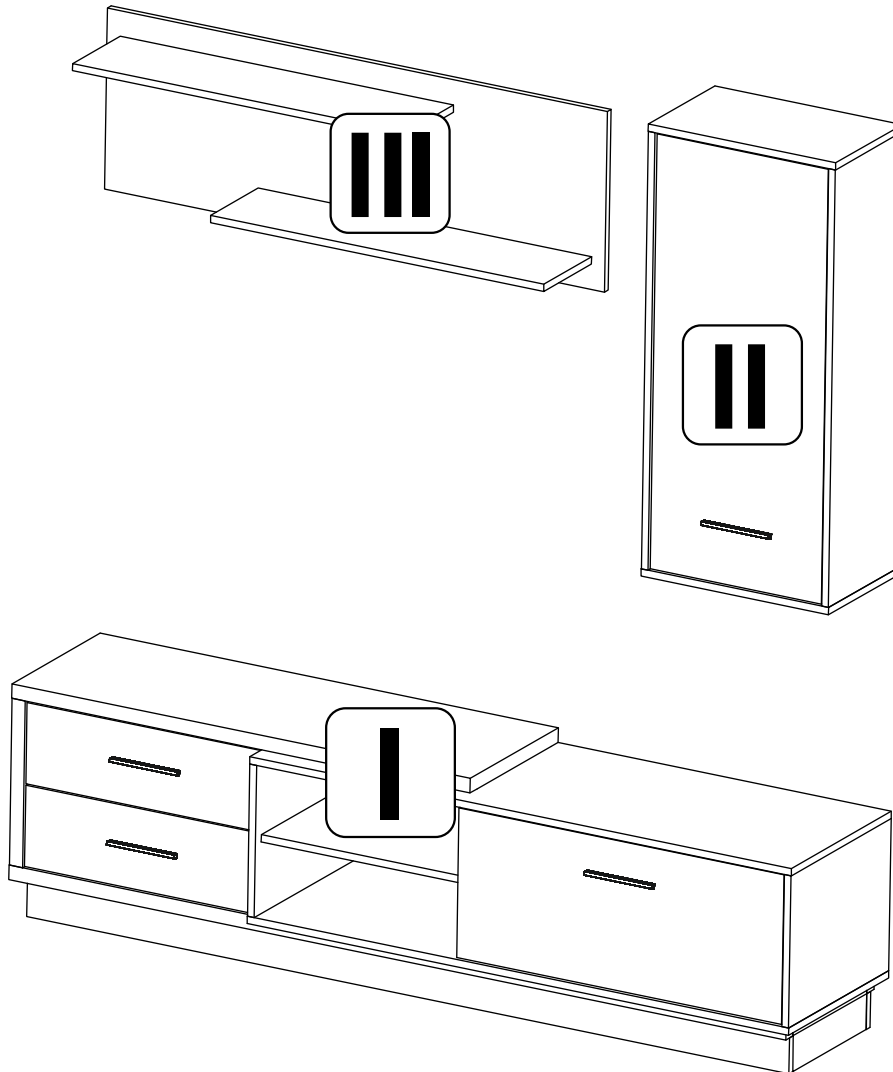

|  |   |   |  |  |  |  |
|--|---|---|--|--|--|--|
| 4x<br><br><b>b19</b>                                 | 4x<br><br><b>a43</b>                                | 52x<br><br>$\phi 15 \times 12 \text{ mm}$ #16 <b>r1</b> | 52x<br><br>20/9 <b>r16</b>                         | 22x<br><br>$\phi 16$ <b>s2</b>                         | 40x<br><br>$\phi 8 \times 30 \text{ mm}$ <b>f1</b> | 12x<br><br>$\phi 5 \times 17 \text{ mm}$ <b>d1</b>   |
| 70x<br><br><b>l1</b>                                 | 2x<br><br>$\phi 6,3 \times 13 \text{ mm}$ <b>e2</b> | 1x<br><br><b>z1</b>                                     | 6x<br><br>$\phi 5$ <b>s4</b>                       | 2x<br><br><b>g2</b>                                    | 4x<br><br>$\phi 5 \times 11 \text{ mm}$ <b>e4</b>  | 6x<br><br>$\phi 3,5 \times 16 \text{ mm}$ <b>p38</b> |
| 8x<br><br>$\phi 3,5 \times 15 \text{ mm}$ <b>p51</b> | 6x<br><br><b>k1</b>                                 | 8x<br><br>$\phi 5 \times 28 \text{ mm}$ <b>e22</b>      | 8x<br><br>$\phi 7 \times 50 \text{ mm}$ <b>e1</b>  | 2x<br><br><b>n10</b>                                   | 8x<br><br>$\phi 4 \times 30 \text{ mm}$ <b>p9</b>  | 4x<br><br><b>c25313</b>                              |
| 6x<br><br>h=16 mm <b>w47</b>                         | 6x<br><br>$\phi 6 \times 28 \text{ mm}$ <b>e25</b>  | 8x<br><br>$\phi 5 \times 50 \text{ mm}$ <b>e32</b>      | 6x<br><br>$\phi 6 \times 13 \text{ mm}$ <b>e3</b>  | 12x<br><br>$\phi 3,5 \times 12 \text{ mm}$ <b>p140</b> | 2x<br><br>L-230 <b>m48</b>                         | 8x<br><br>$\phi 3,5 \times 13 \text{ mm}$ <b>p1</b>  |
| 4x<br><br>350 <b>w207/1</b>                          | 4x<br><br>350 <b>w207/2</b>                         | 2x<br><br><b>n1221</b>                                  | 4x<br><br>$\phi 4 \times 30 \text{ mm}$ <b>p21</b> |  |  |  |

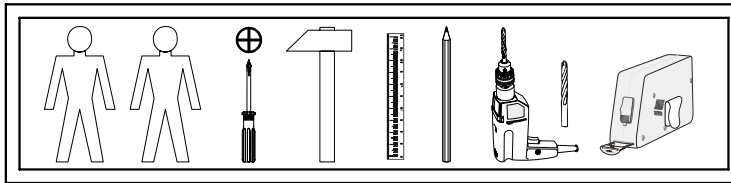
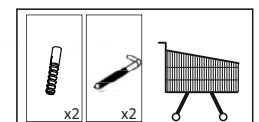
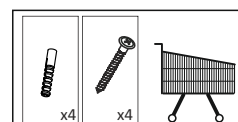

# I

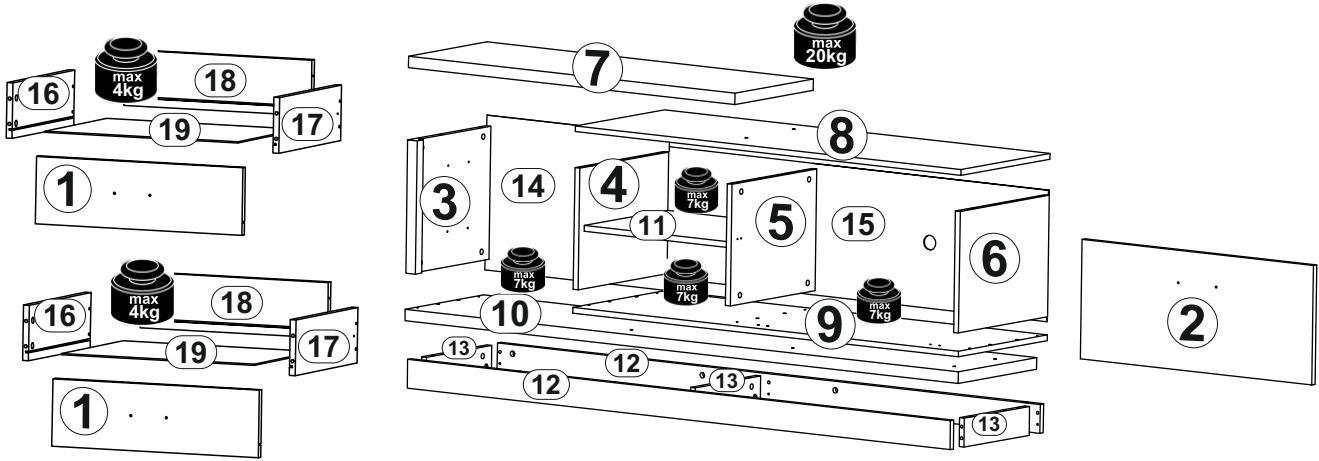

| A  | B       | C    | D   |     |
|----|---------|------|-----|-----|
| 1  | SU1-003 | 562  | 180 | 1/3 |
| 2  | SU1-002 | 780  | 331 | 3/3 |
| 3  | SU1-103 | 369  | 370 | 1/3 |
| 4  | SU1-104 | 337  | 420 | 1/3 |
| 5  | SU1-106 | 337  | 400 | 1/3 |
| 6  | SU1-105 | 337  | 420 | 1/3 |
| 7  | SU1-202 | 1100 | 370 | 3/3 |
| 8  | SU1-204 | 1300 | 420 | 2/3 |
| 9  | SU1-205 | 1300 | 420 | 2/3 |
| 10 | SU1-203 | 1865 | 370 | 2/3 |

| A  | B       | C    | D   |     |
|----|---------|------|-----|-----|
| 11 | SU1-303 | 483  | 395 | 2/3 |
| 12 | SU1-402 | 1830 | 80  | 2/3 |
| 13 | SU1-403 | 308  | 80  | 2/3 |
| 14 | SU1-902 | 605  | 429 | 2/3 |
| 15 | SU1-903 | 1288 | 364 | 2/3 |
| 16 | SU1-502 | 350  | 140 | 1/3 |
| 17 | SU1-503 | 350  | 140 | 1/3 |
| 18 | SU1-501 | 510  | 140 | 1/3 |
| 19 | SU1-904 | 525  | 349 | 2/3 |

# 1



- 4x  $\phi 3.5 \times 15$  mm p51
- 2x a43
- 28x  $\phi 1.5 \times 12$  mm #16 r1
- 28x  $\phi 8 \times 30$  mm f1
- 6x h=16 mm w47
- 6x  $\phi 6 \times 28$  mm e25
- 4x 350 w207/2
- 6x  $\phi 6 \times 13$  mm e3

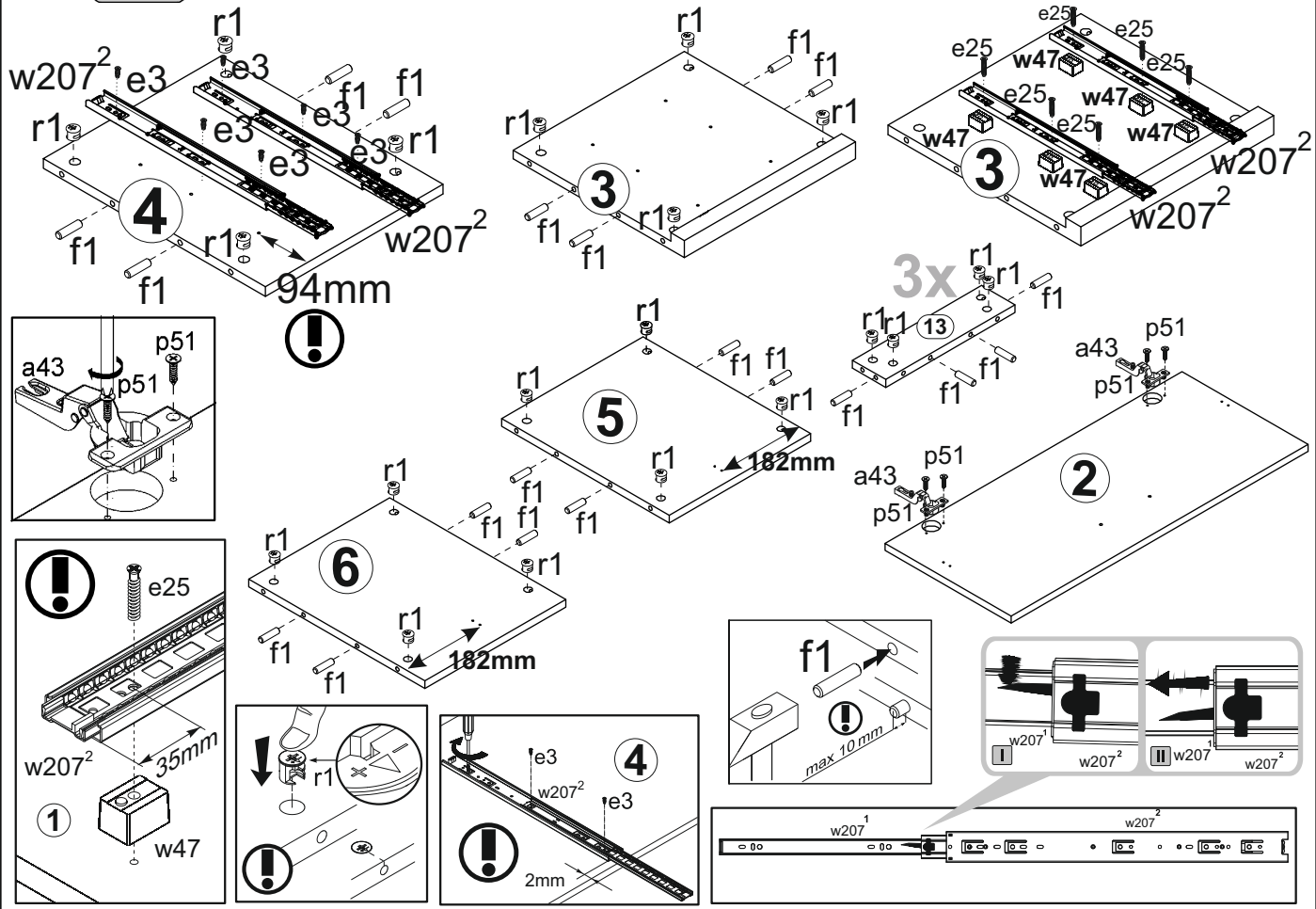

# 2

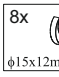
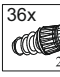
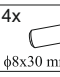
- 2x  b19
- 8x  r1
- 36x  r16
- 4x  f1

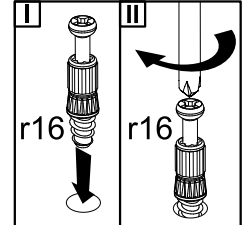
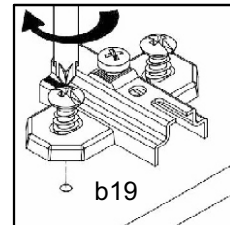
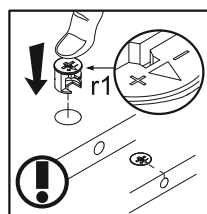
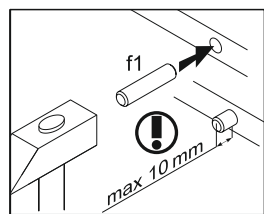
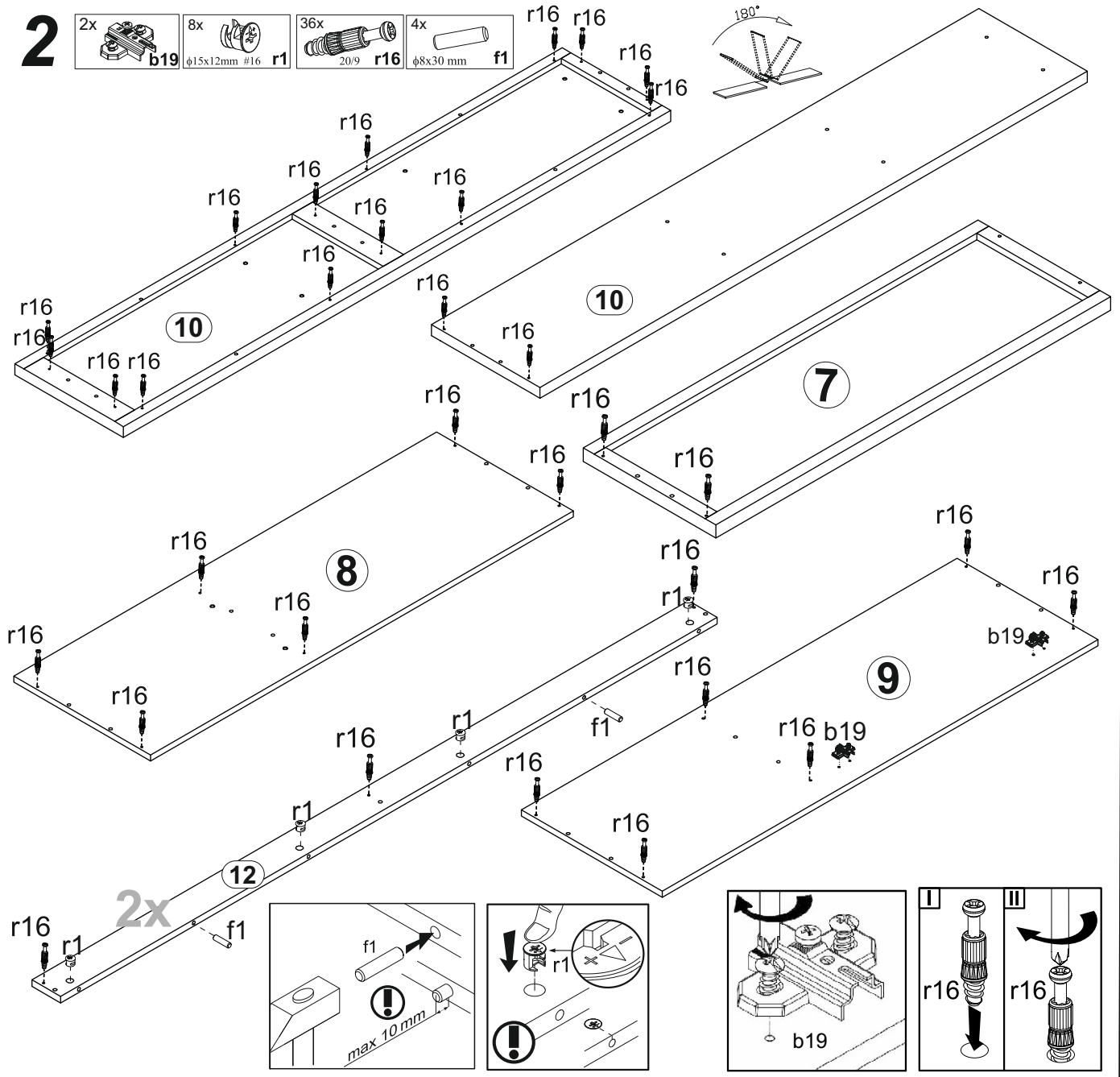
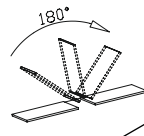

# 3

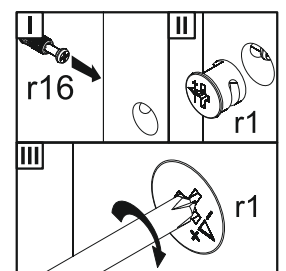
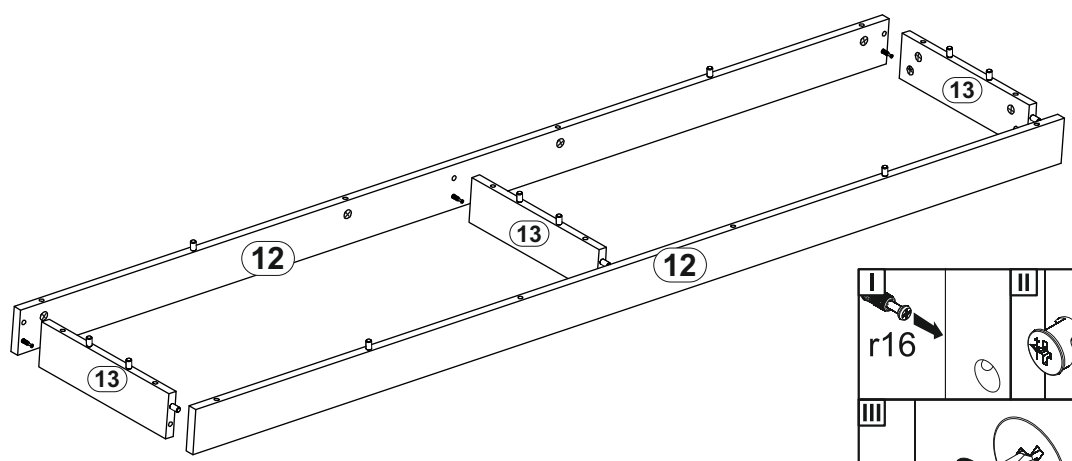

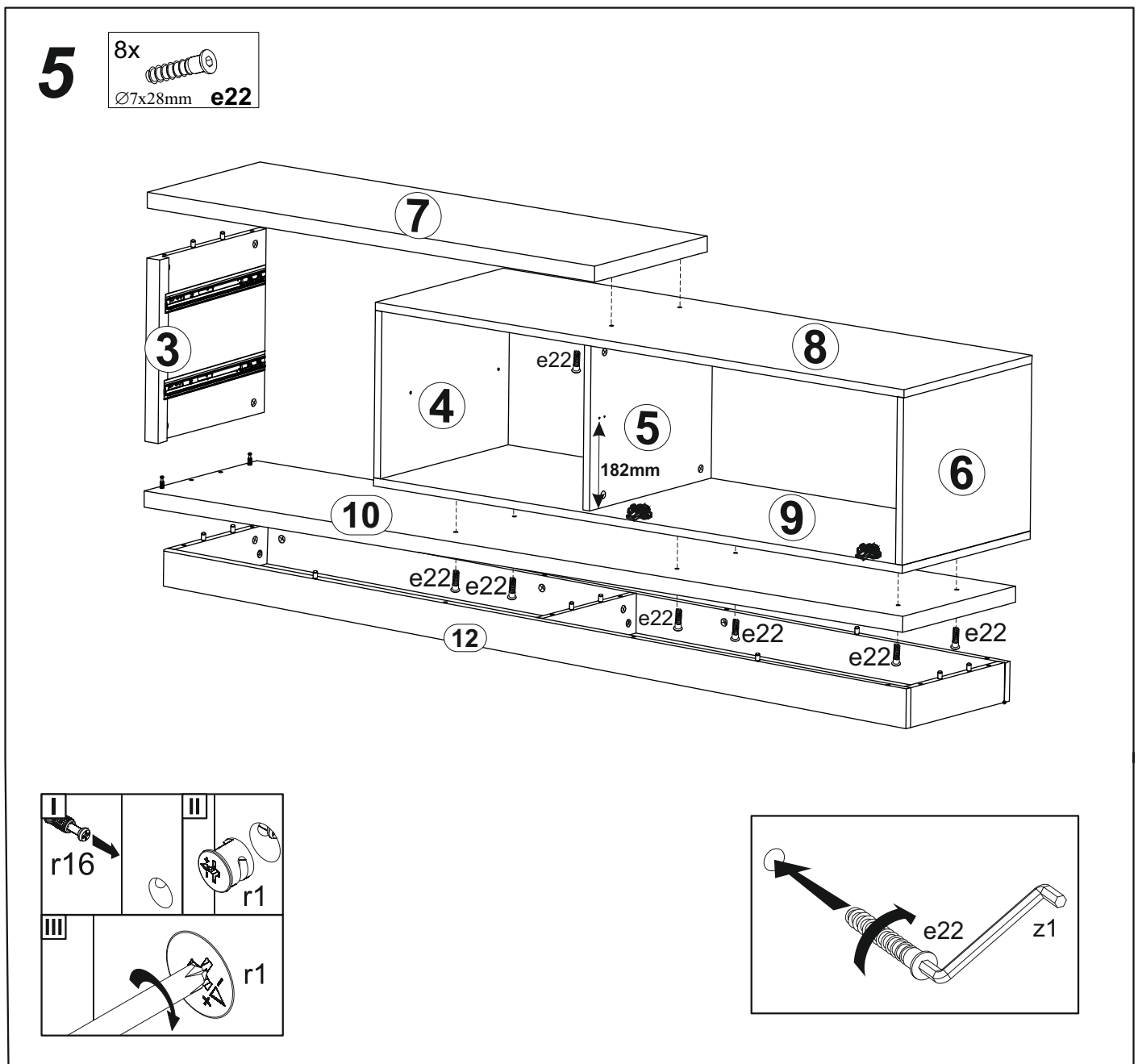
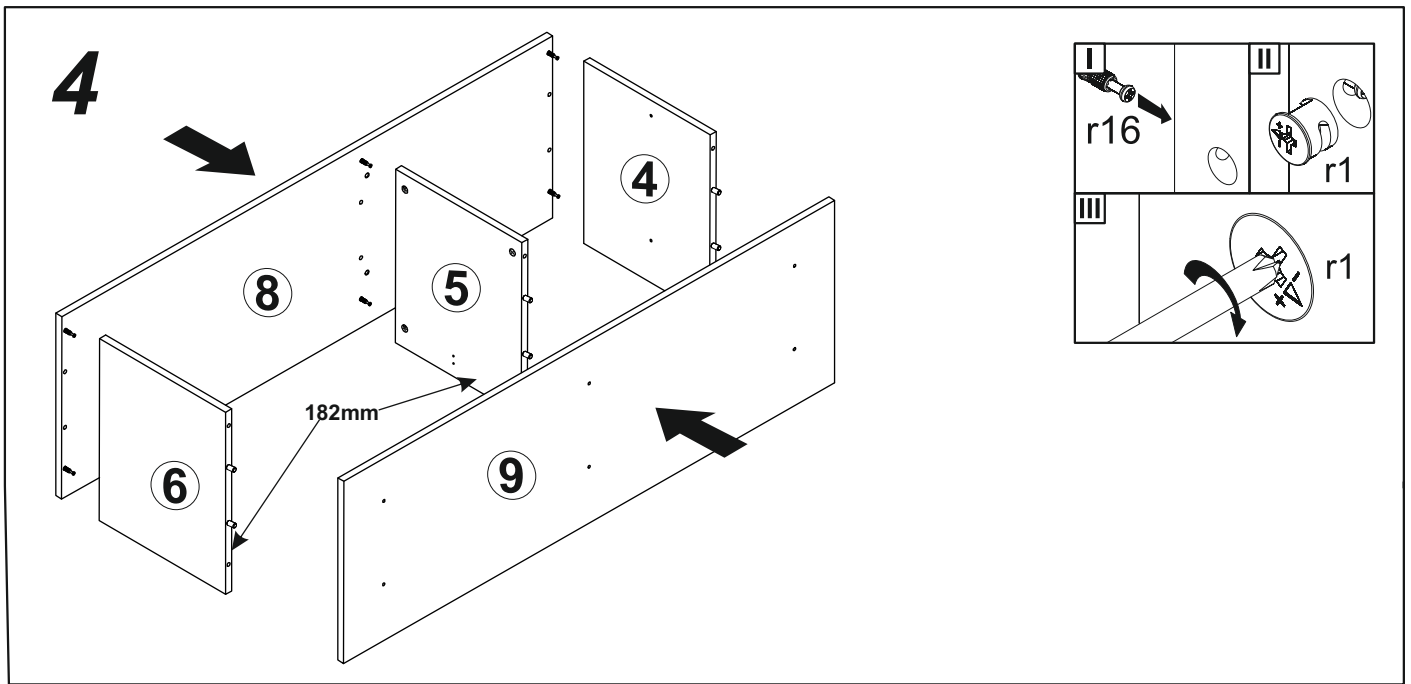

# 6

- 8x  $\phi 5 \times 50$  mm e32
- 12x  $\phi 3,5 \times 12$  mm p140
- 4x w207/1
- 8x  $\phi 15 \times 12$  mm #16 r1
- 8x 20,9 r16
- 8x  $\phi 16$  s2
- 4x  $\phi 4 \times 30$  mm p9
- 2x c253\3

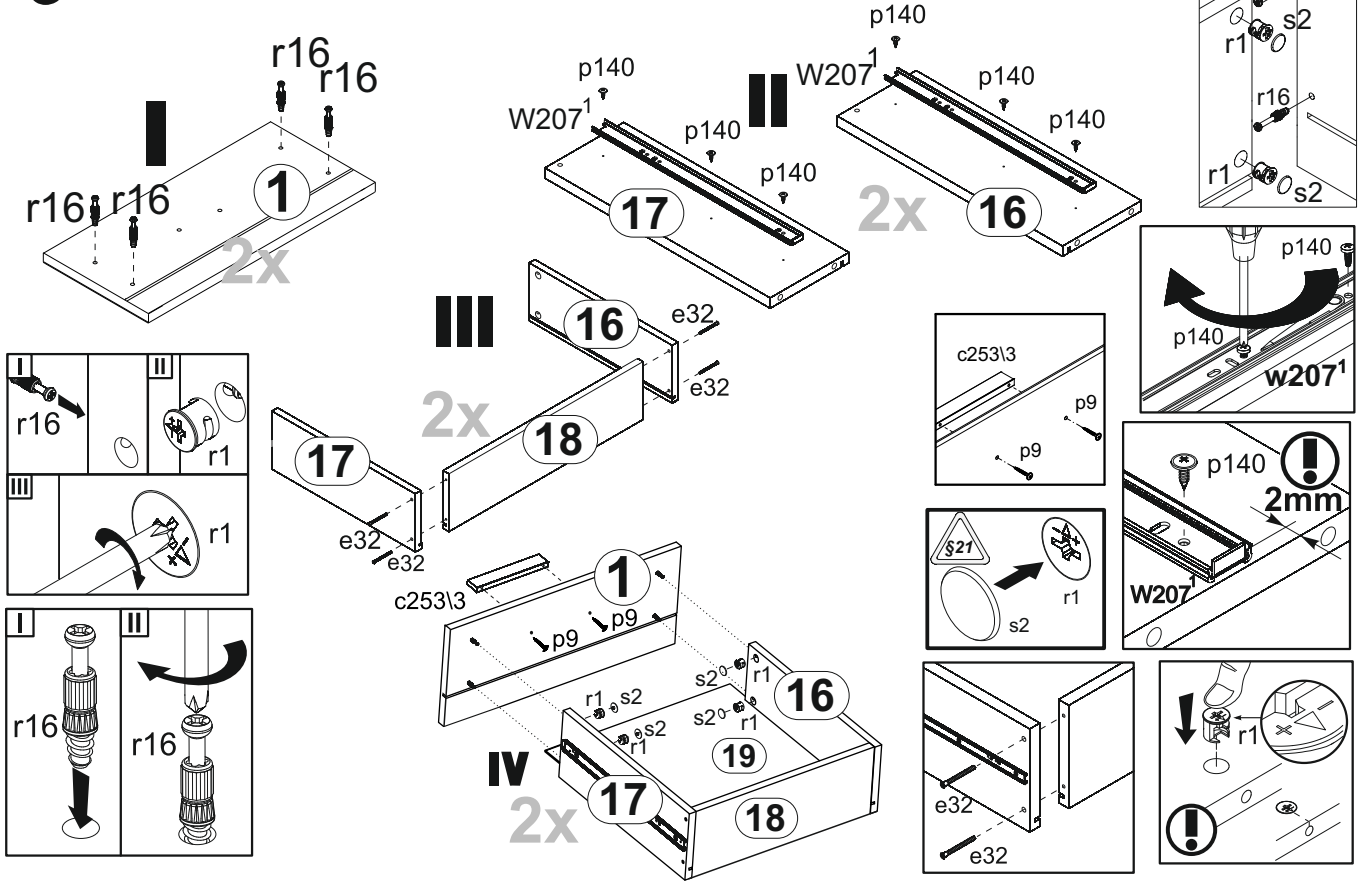

# 7

- 6x k1
- 40x l1
- 6x  $\phi 3,5 \times 16$  mm p38

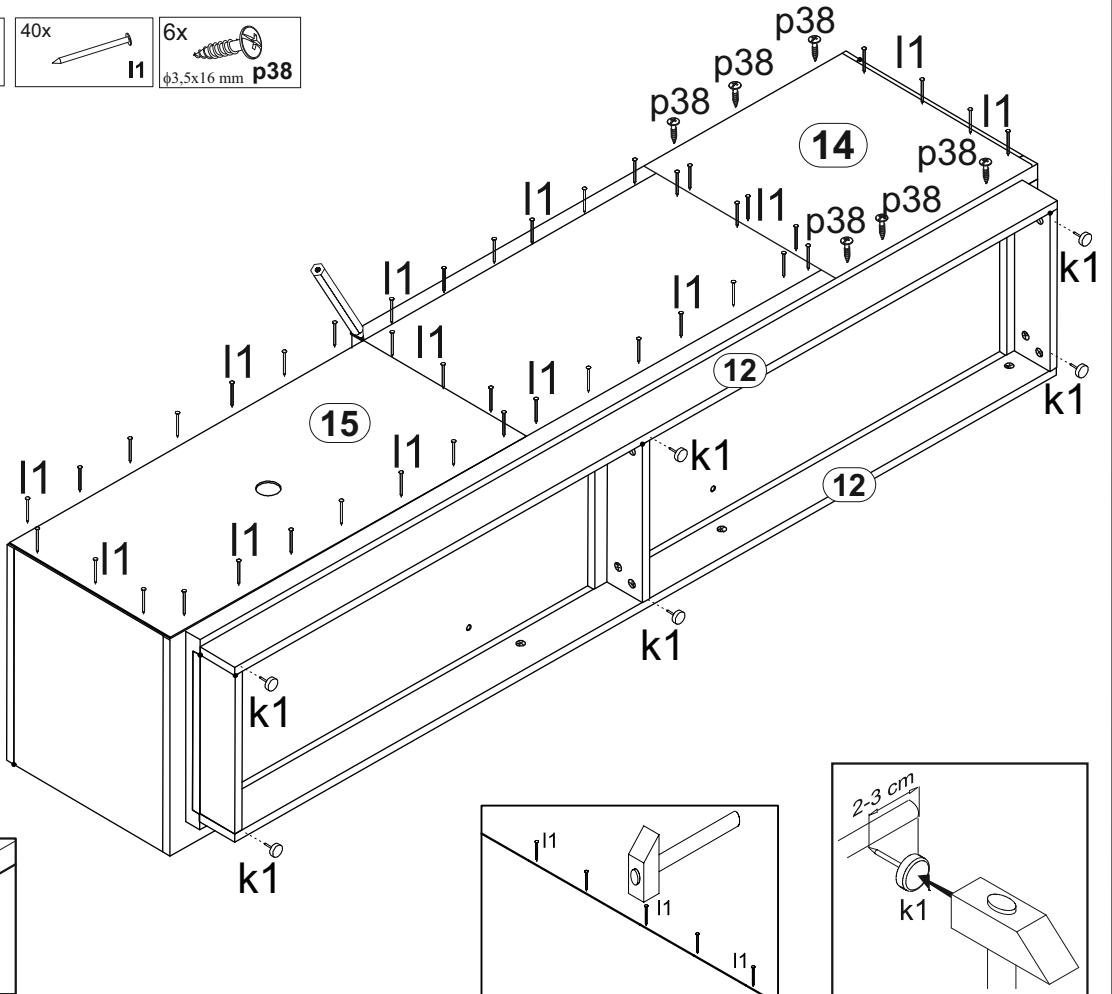
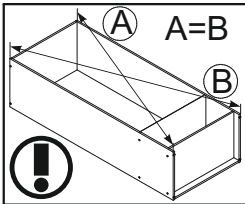

# 8

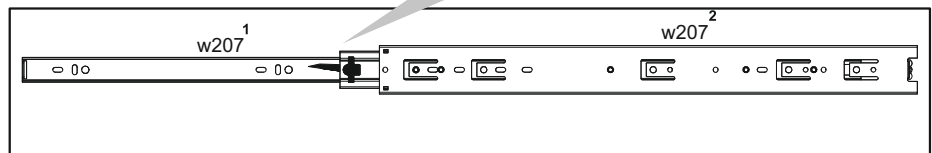
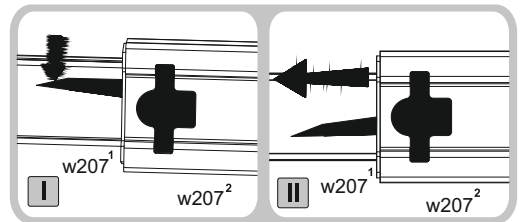
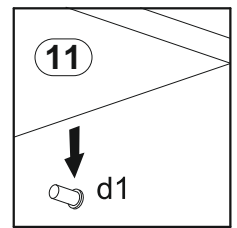
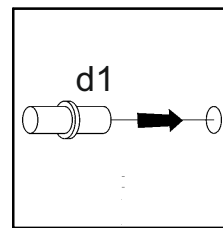
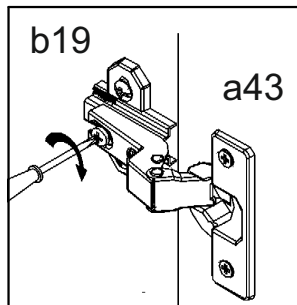
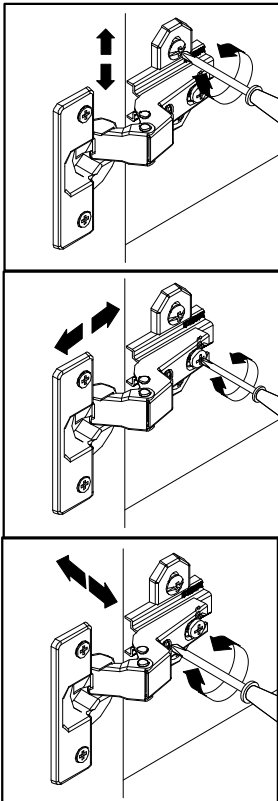
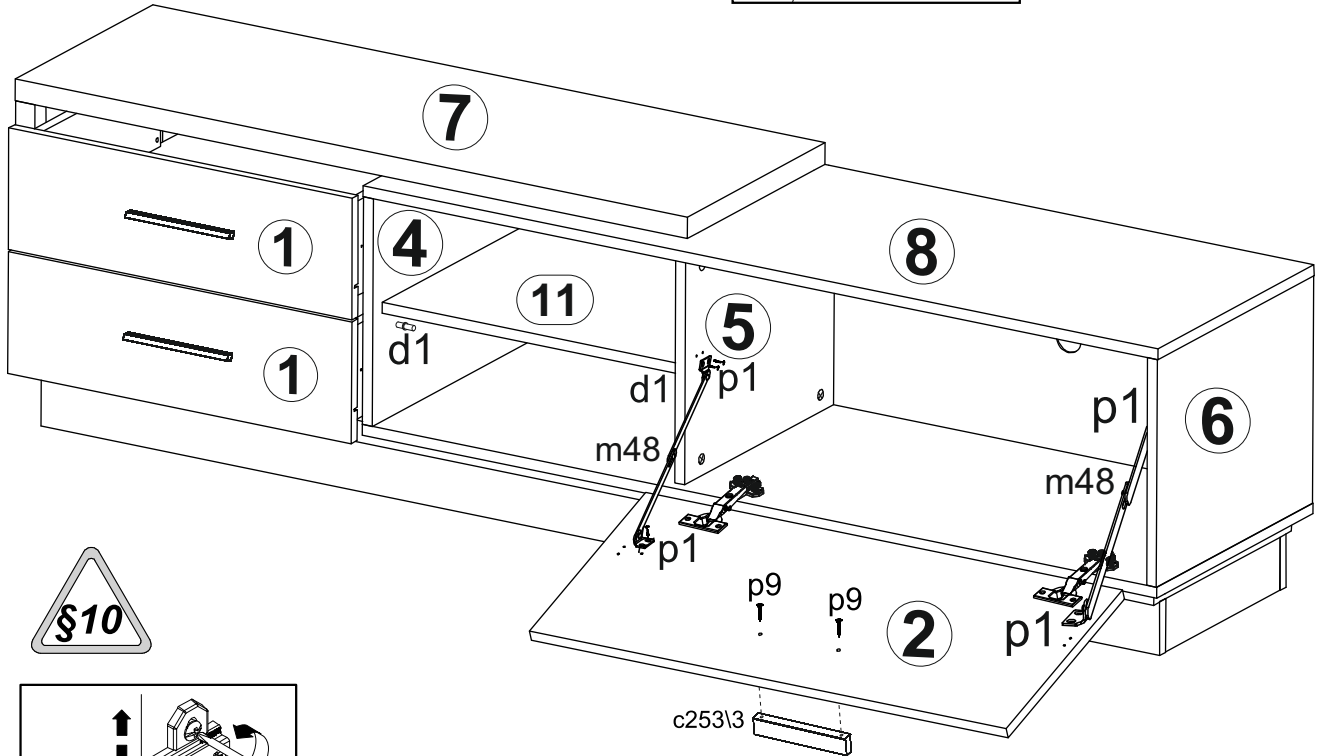
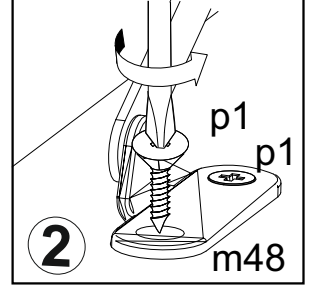
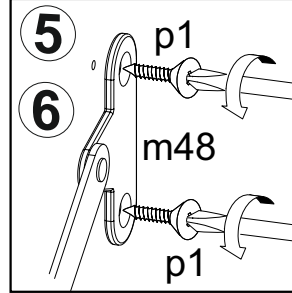
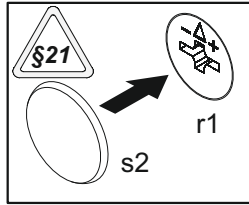
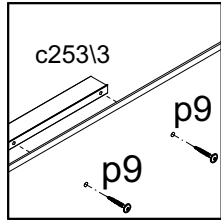
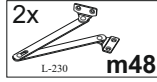
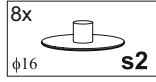
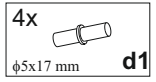
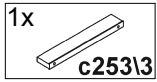
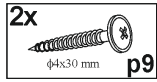

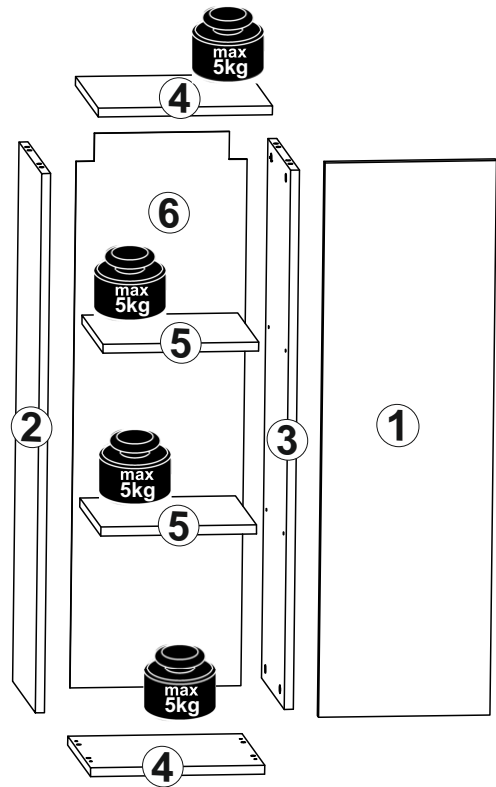
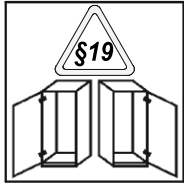

| A | B       | C   |     | D   |
|---|---------|-----|-----|-----|
| 1 | SU1-001 | 962 | 411 | 3/3 |
| 2 | SU1-101 | 968 | 280 | 1/3 |
| 3 | SU1-102 | 968 | 280 | 1/3 |
| 4 | SU1-201 | 450 | 480 | 1/3 |
| 5 | SU1-301 | 417 | 260 | 2/3 |
| 6 | SU1-901 | 995 | 444 | 2/3 |

**1**

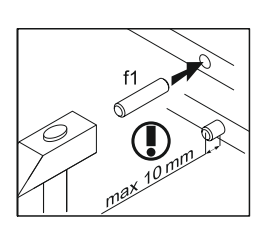
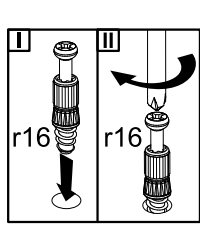
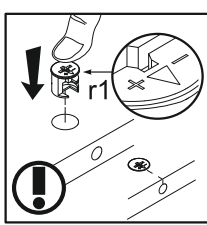
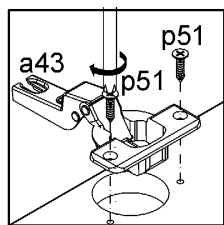
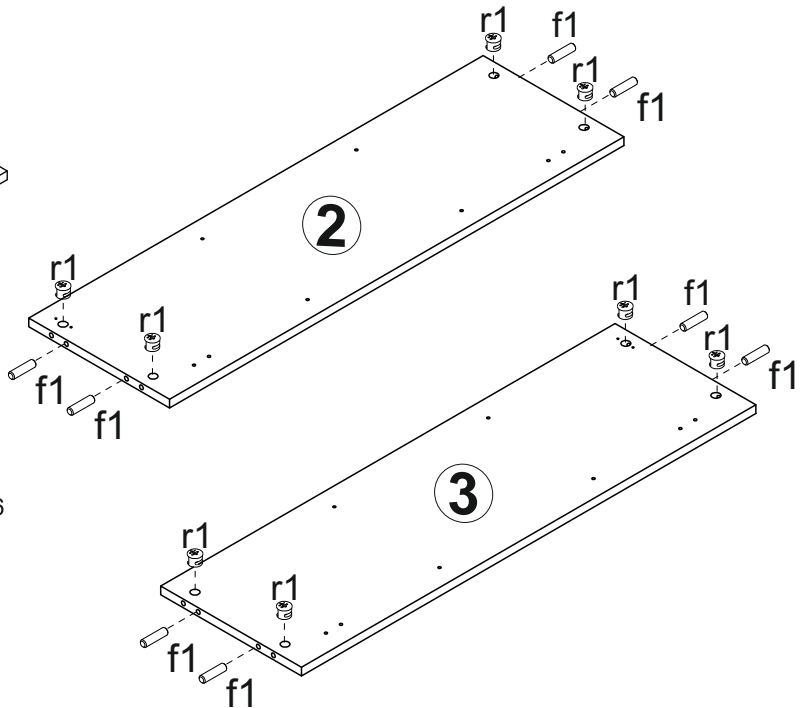
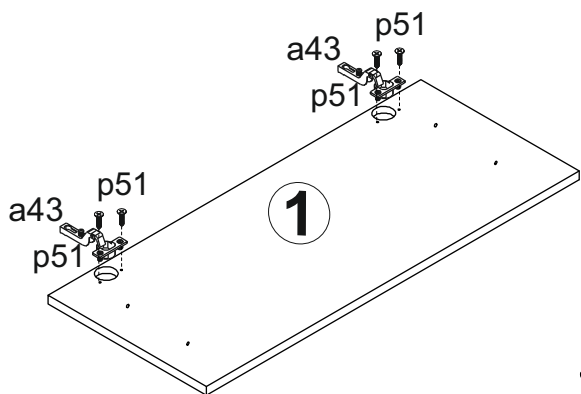
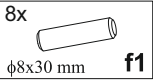
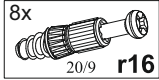
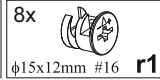
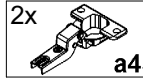



# 2

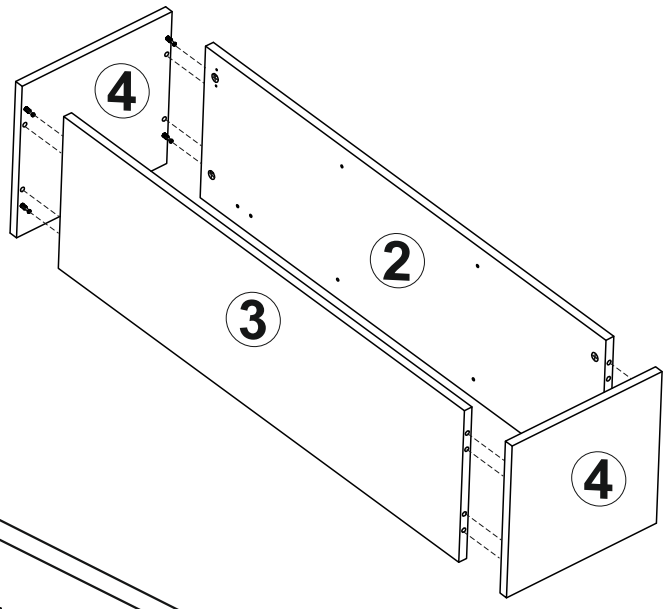
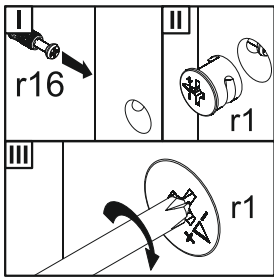

# 3

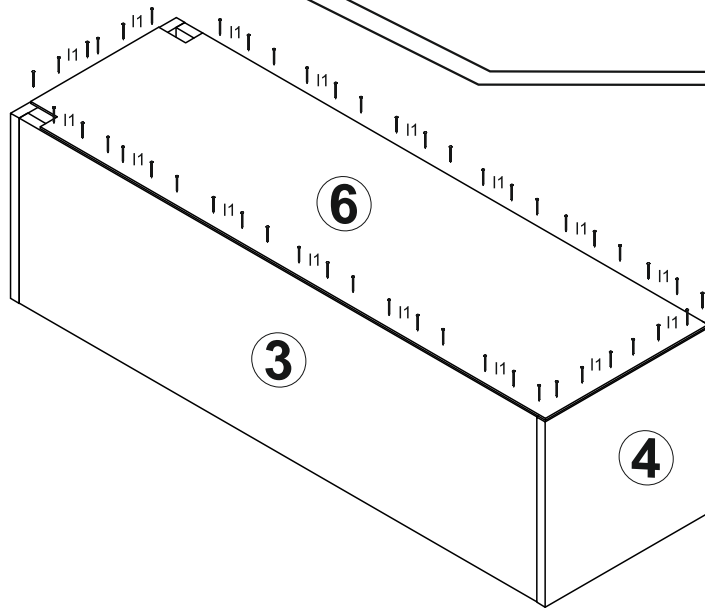
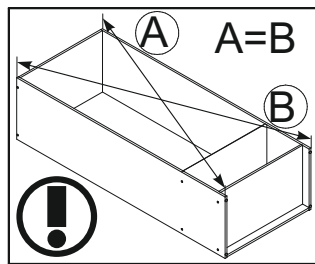
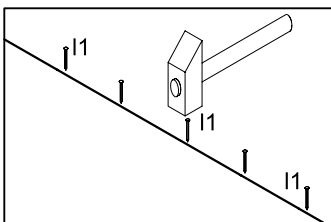

# 4

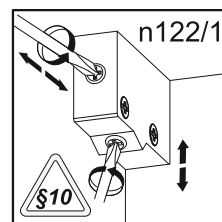
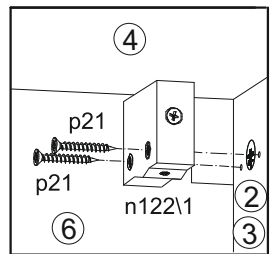
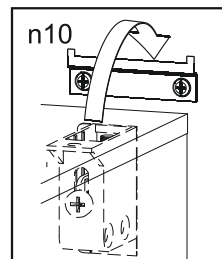
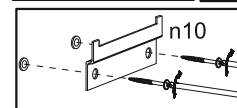
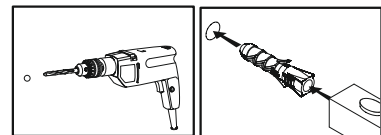
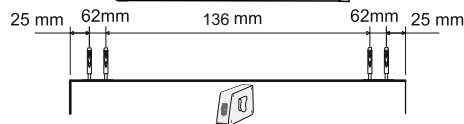
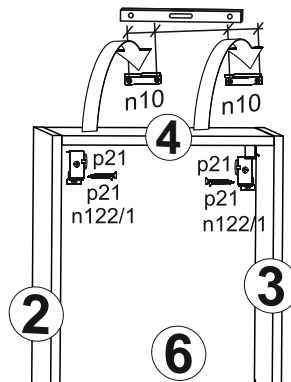
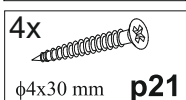
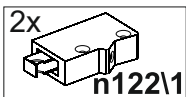
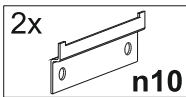
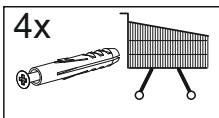



# 5

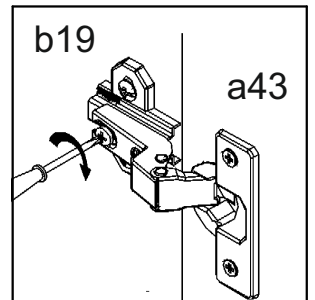
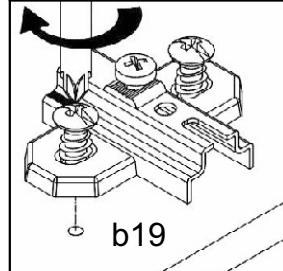
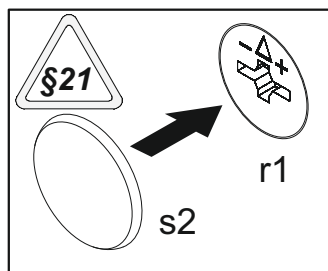
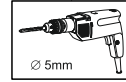
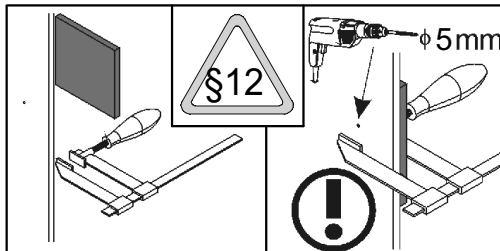
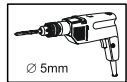
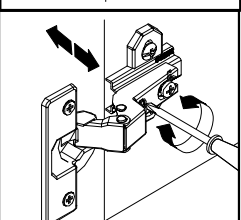
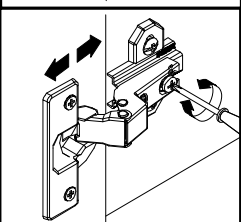
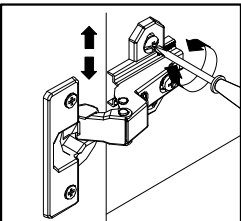
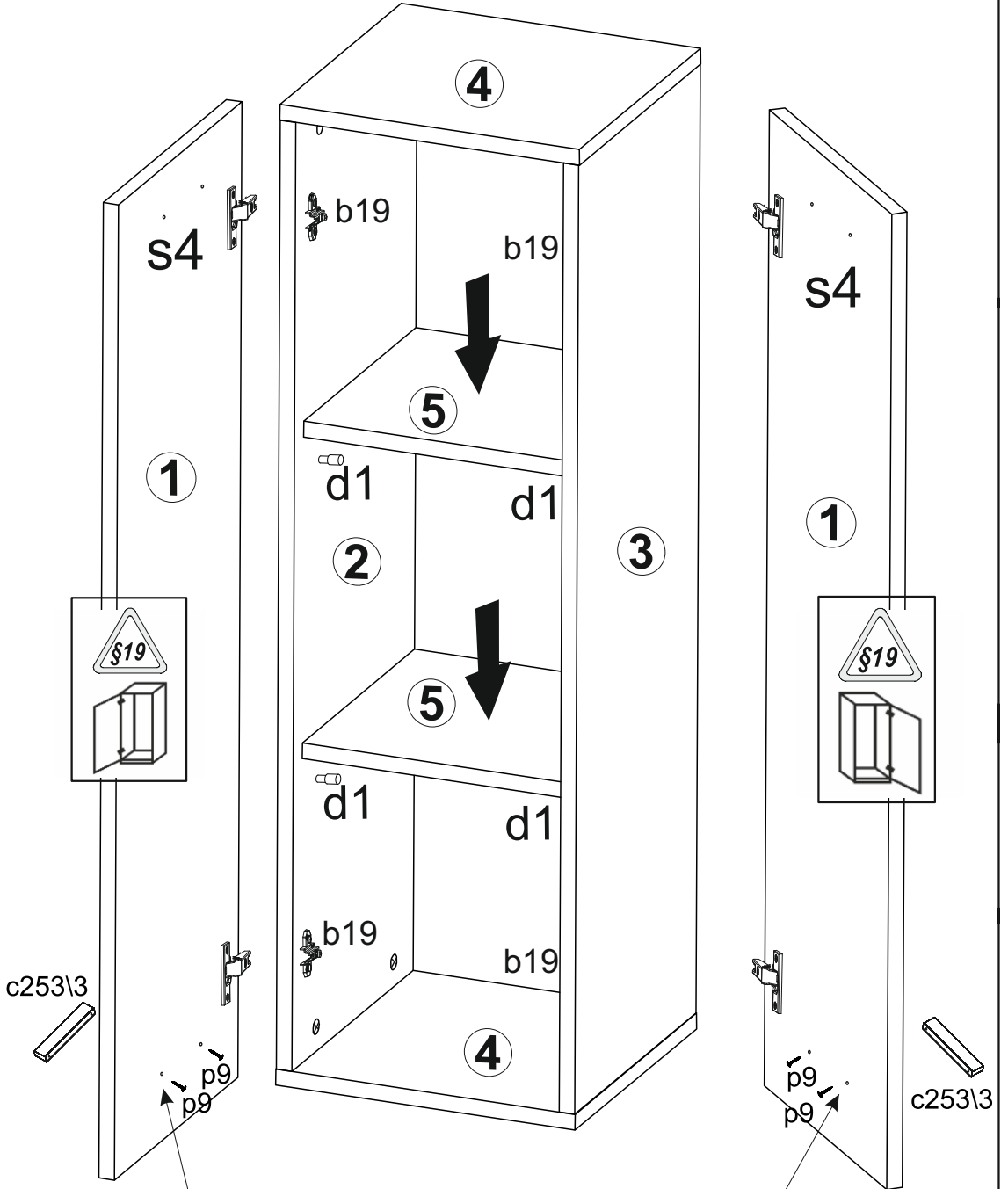
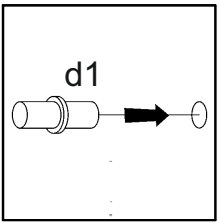
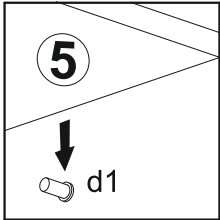
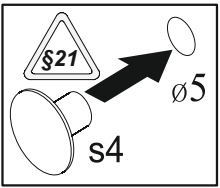
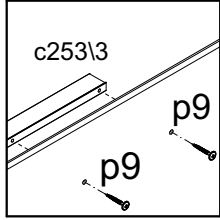
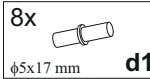
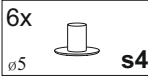
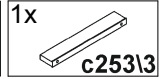
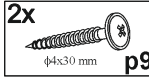
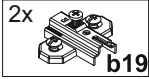



| A | B       | C    |     | D   |
|---|---------|------|-----|-----|
| 1 | SU1-401 | 1200 | 400 | 3/3 |
| 2 | SU1-302 | 800  | 200 | 3/3 |

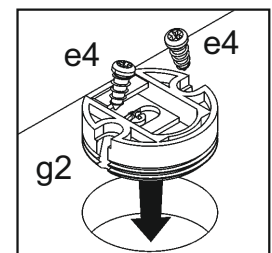
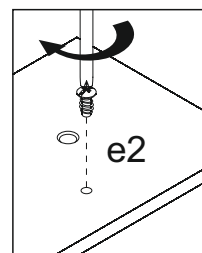
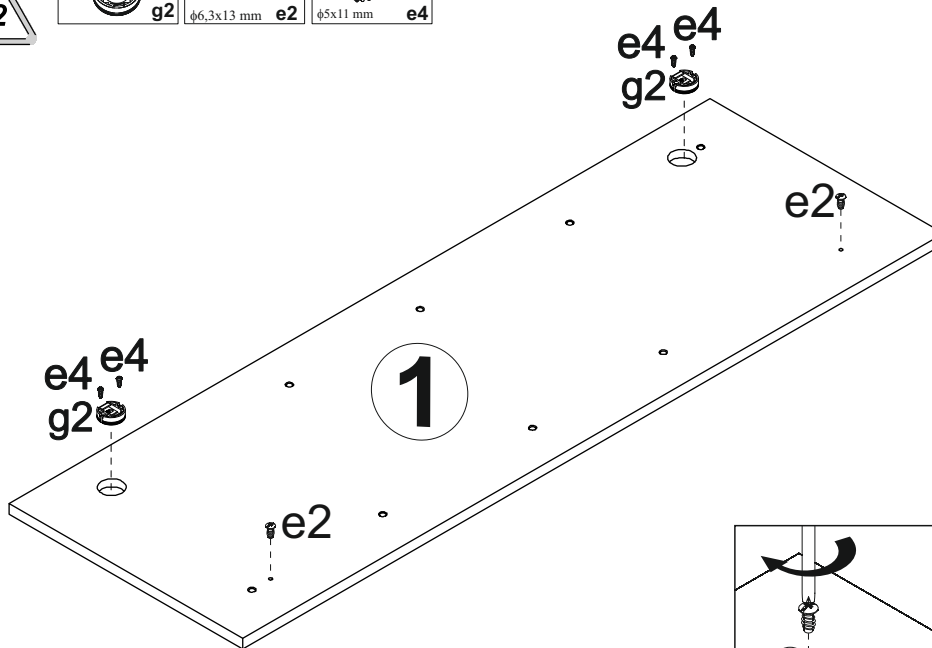
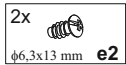
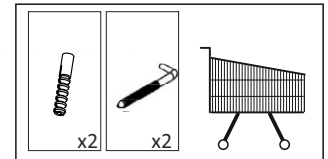
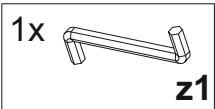
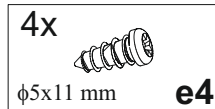
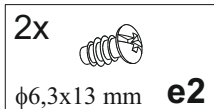
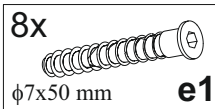
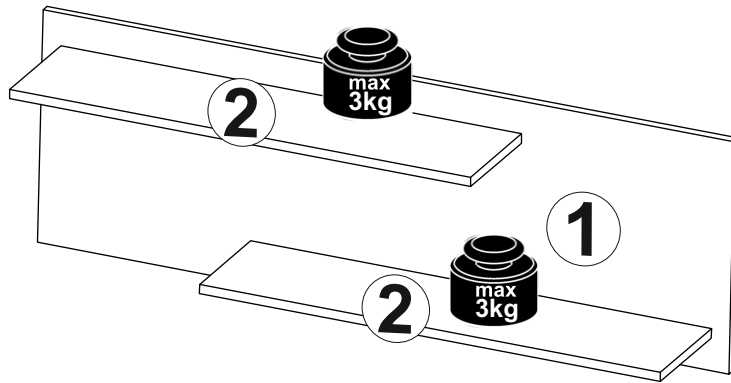

2

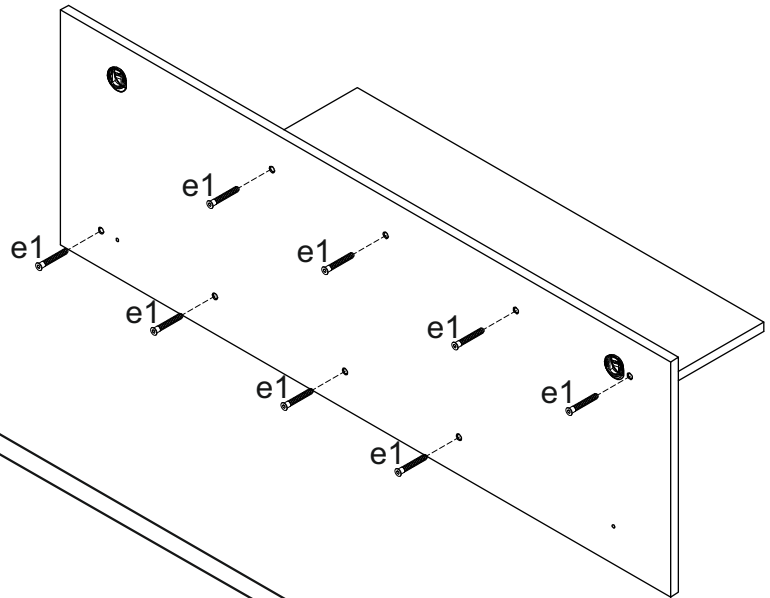
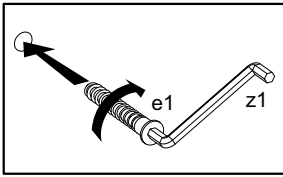
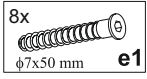

3

