

2x a43	2x b19	2x a68	2x b33	8x p51 φ3,5x15 mm	3x f6 φ8x50 mm
28x f1 φ8x30 mm	28x r1 φ15x12mm #16	26x r16 20/9	1x r10 62 mm	26x s2 φ16	16x d1 φ5x17 mm
4x m48 L-230	16x p1 φ3,5x13 mm	1x n14 81x21	2x p5 φ3,5x13 mm	2x c68	2x j8 M4x25 mm
8x k55 60x60/25 mm	16x p6 φ4x35 mm	2x n2	2x n3 50x12/1,5 mm	4x p27 φ3,5x13 mm	4x p400 φ3x10 mm
13x e1 φ7x50 mm	4x j45¹ M4x12 mm	2x j45²	8x r36 φ20x12mm #16	8x r37 6,7/7,8	52x l1
5x g500 32 mm	10x j30 M4x22 mm	4x n108 20x13x3,5/1 mm	4x p55 φ2,9x16 mm	1x z1	x1 x1 x1

# I

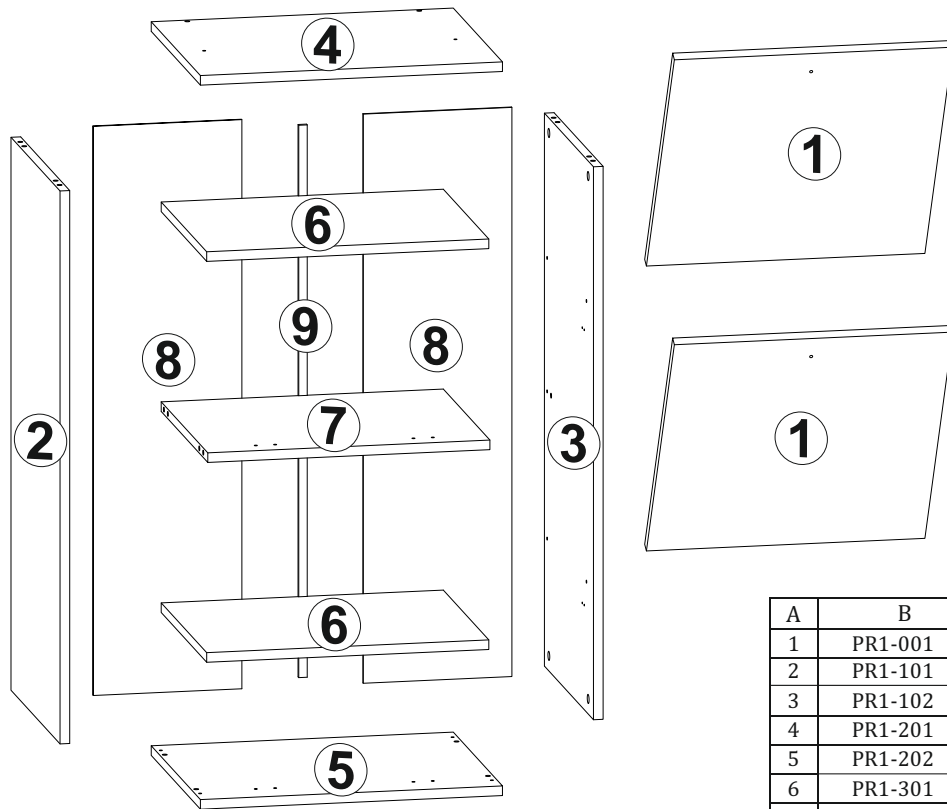

A	B	C	D	
1	PR1-001	455	461	3/4
2	PR1-101	920	399	3/4
3	PR1-102	920	399	3/4
4	PR1-201	500	400	3/4
5	PR1-202	500	400	3/4
6	PR1-301	467	370	3/4
7	PR1-302	467	379	3/4
8	PR1-901	947	246	3/4
9	LH-919	919	14	3/4

# 1

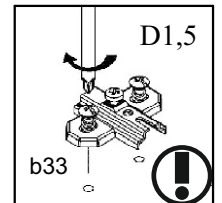
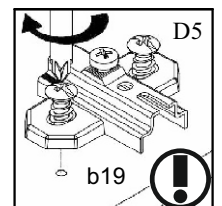
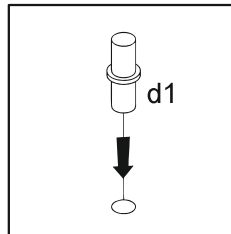
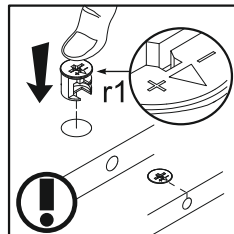
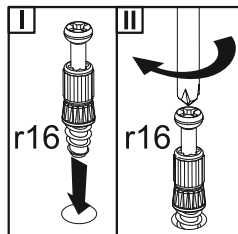
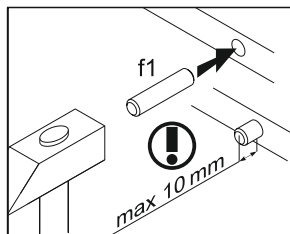
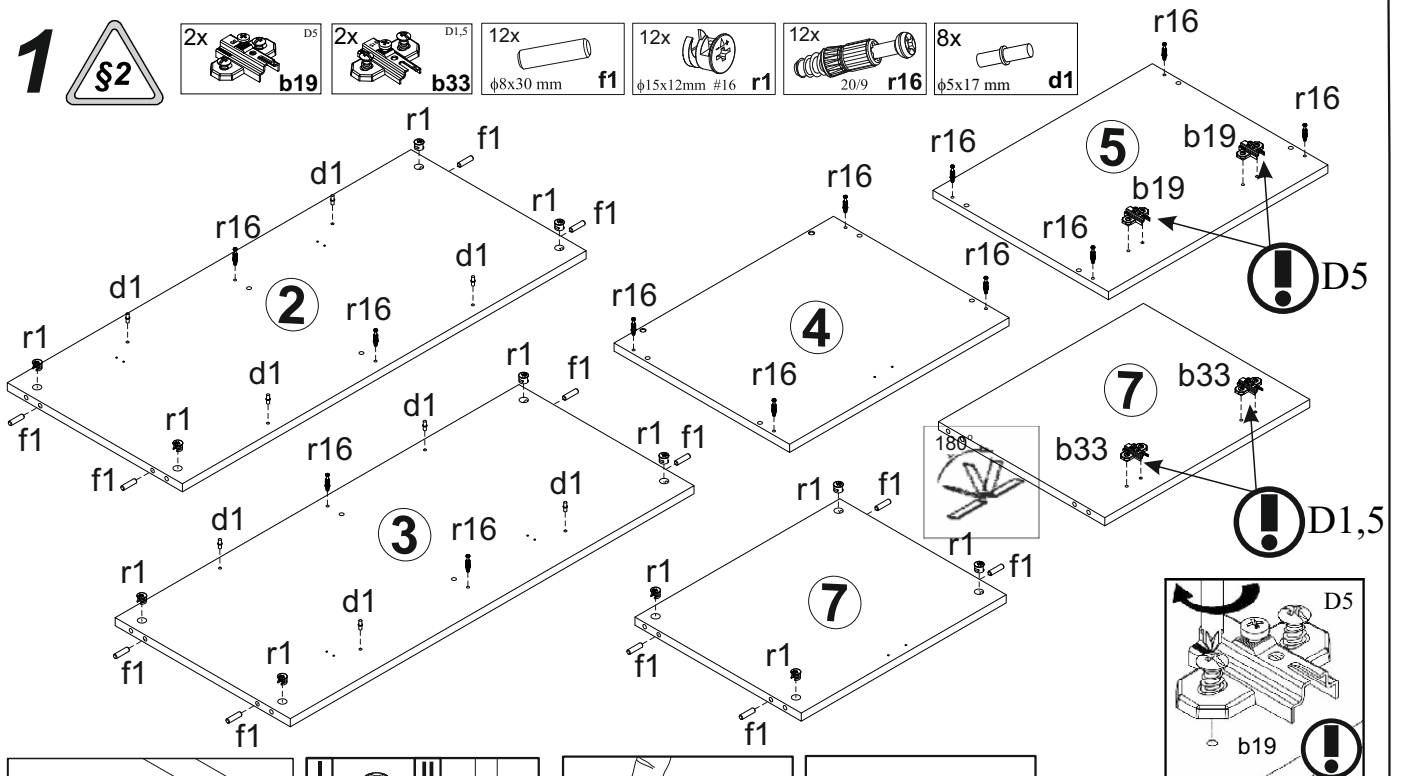
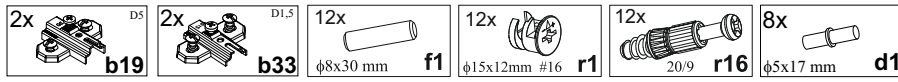

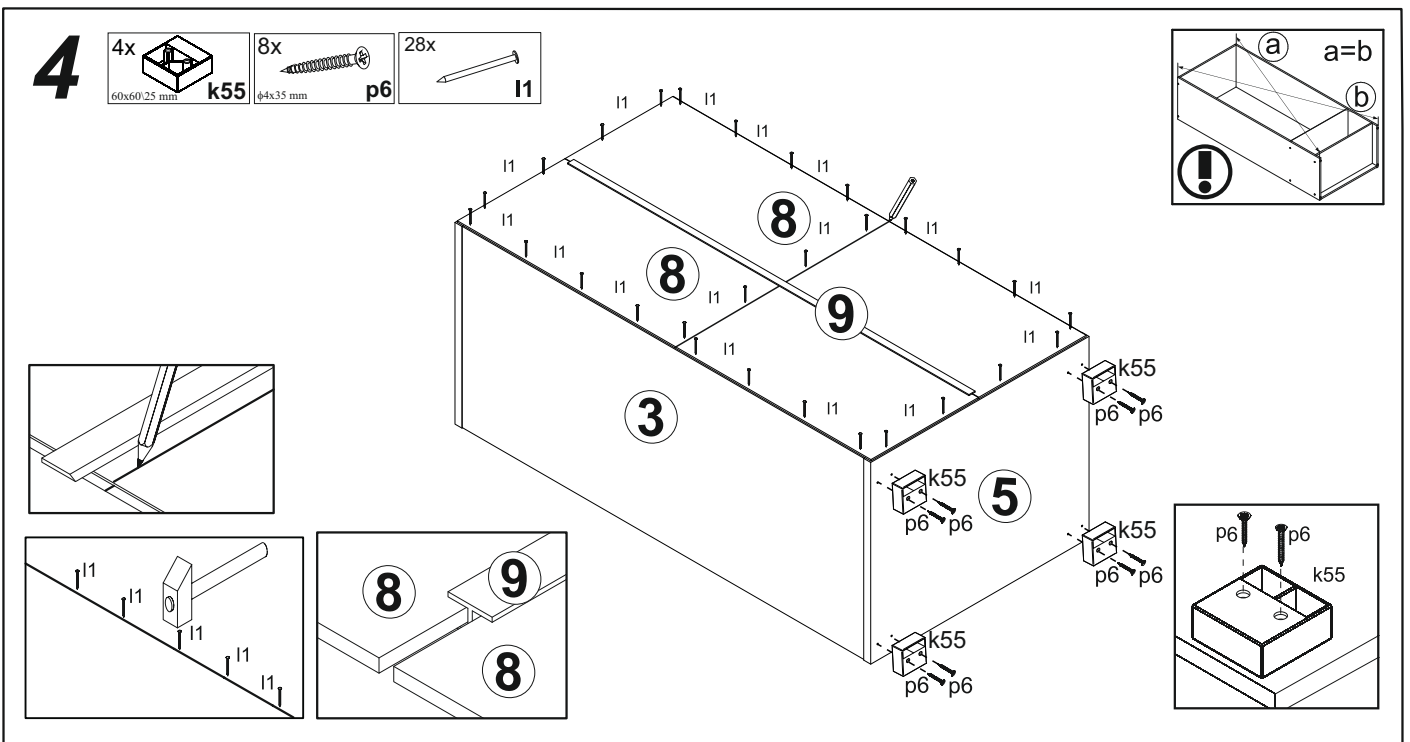
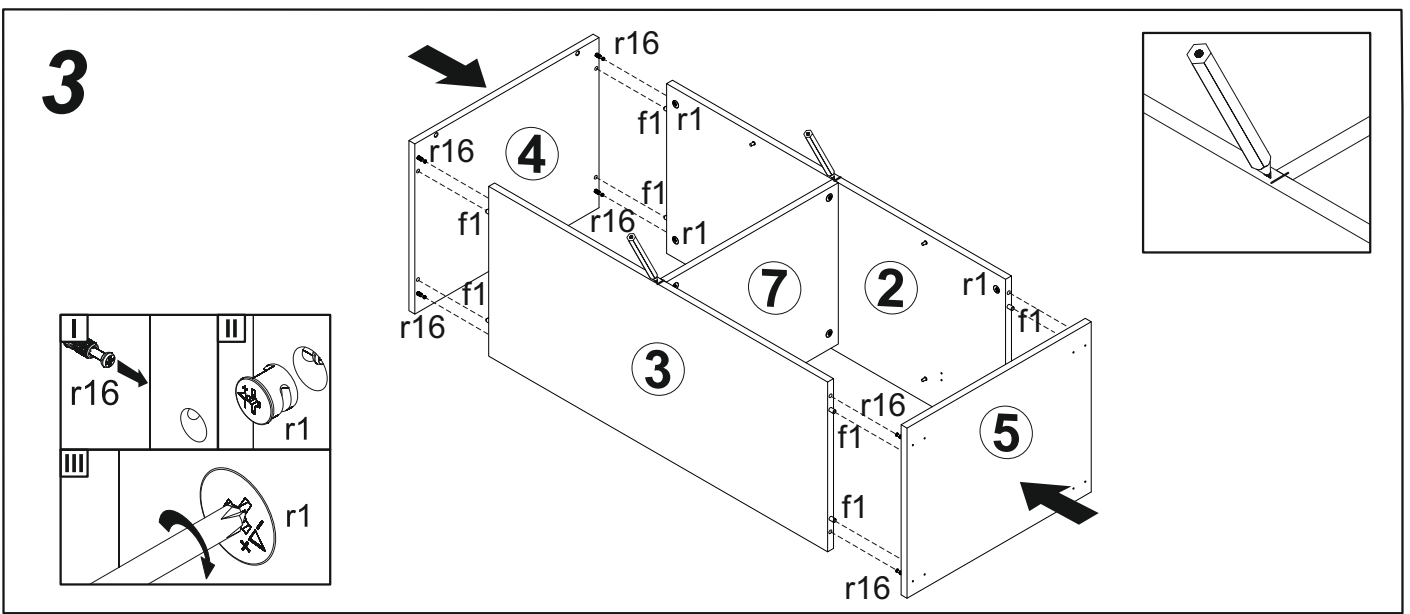
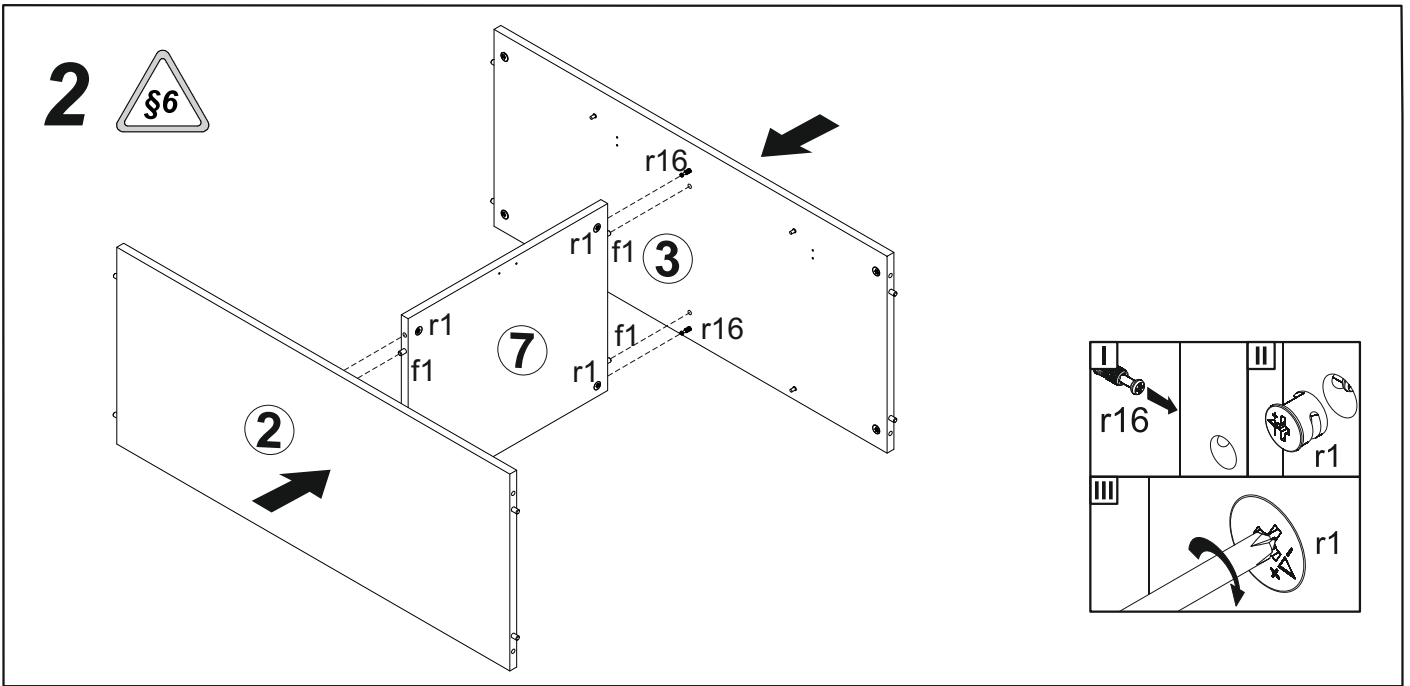

# 5

- 2x a43
- 2x a68
- 8x  $\phi 3,5 \times 15$  mm p51
- 2x 50x12x1,5 mm n3
- 4x  $\phi 3 \times 10$  mm p400

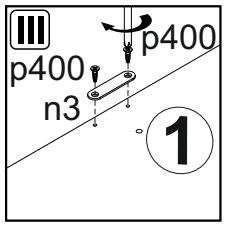
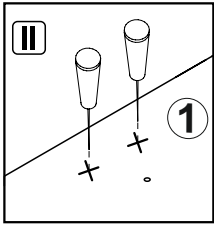
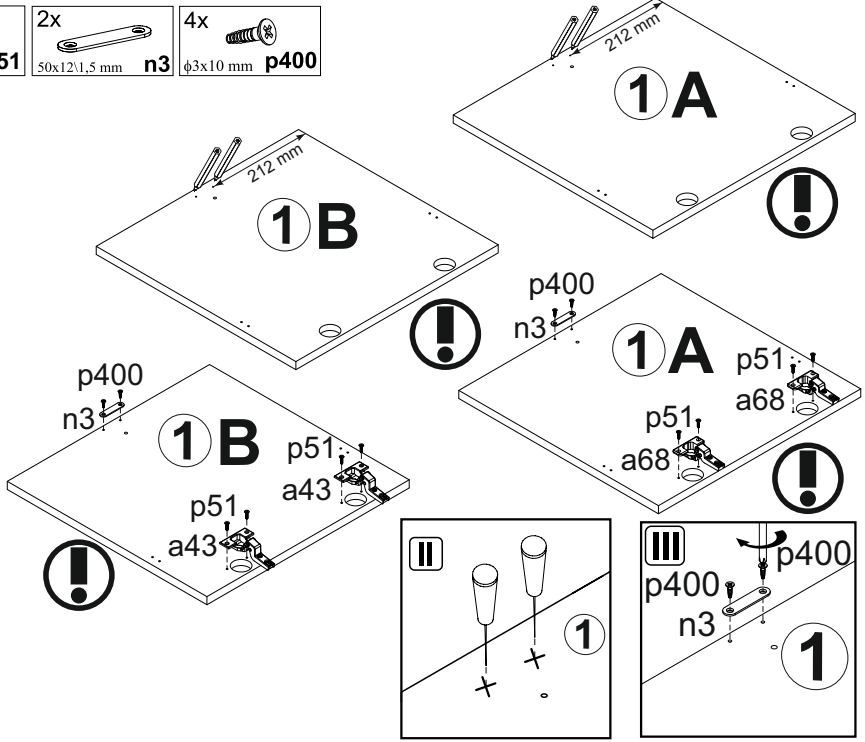
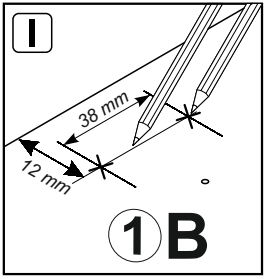
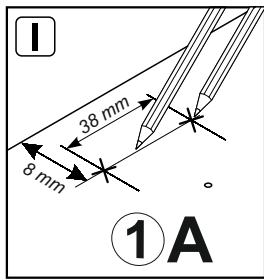
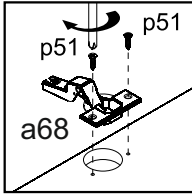
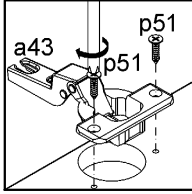
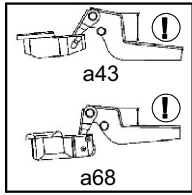

# 6

- 4x L-230 m48
- 16x  $\phi 3,5 \times 13$  mm p1
- 2x n2
- 4x  $\phi 3,5 \times 13$  mm p27
- 2x c68
- 2x M4x25 mm j8
- 12x  $\phi 16$  s2

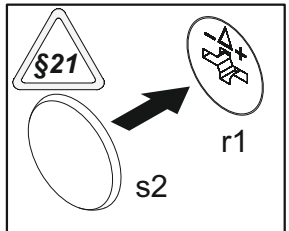
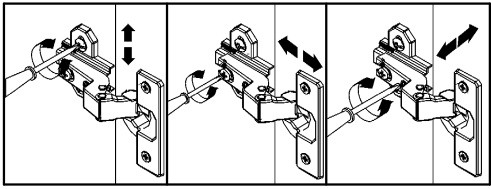
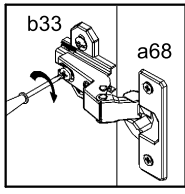
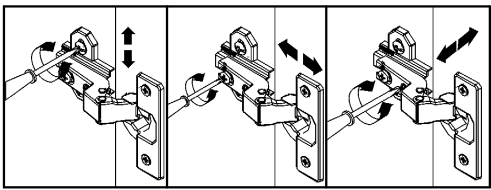
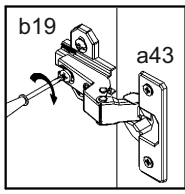
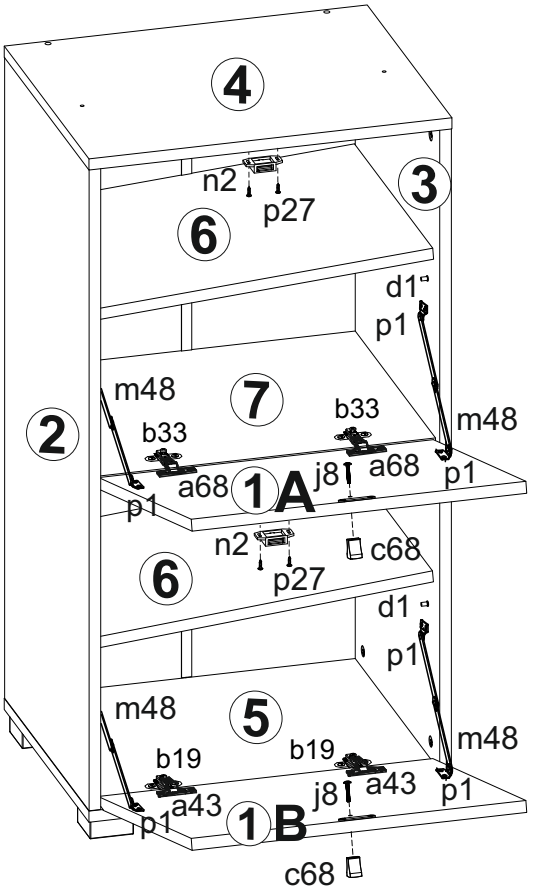
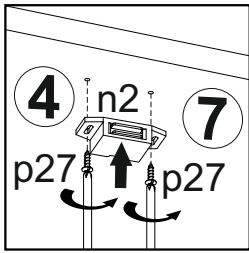
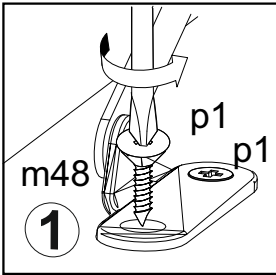
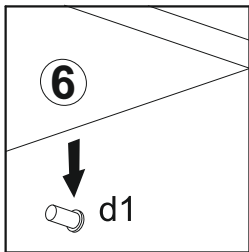
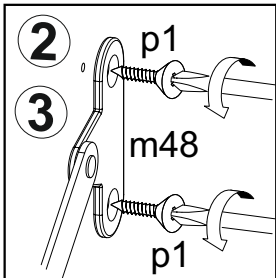

## II

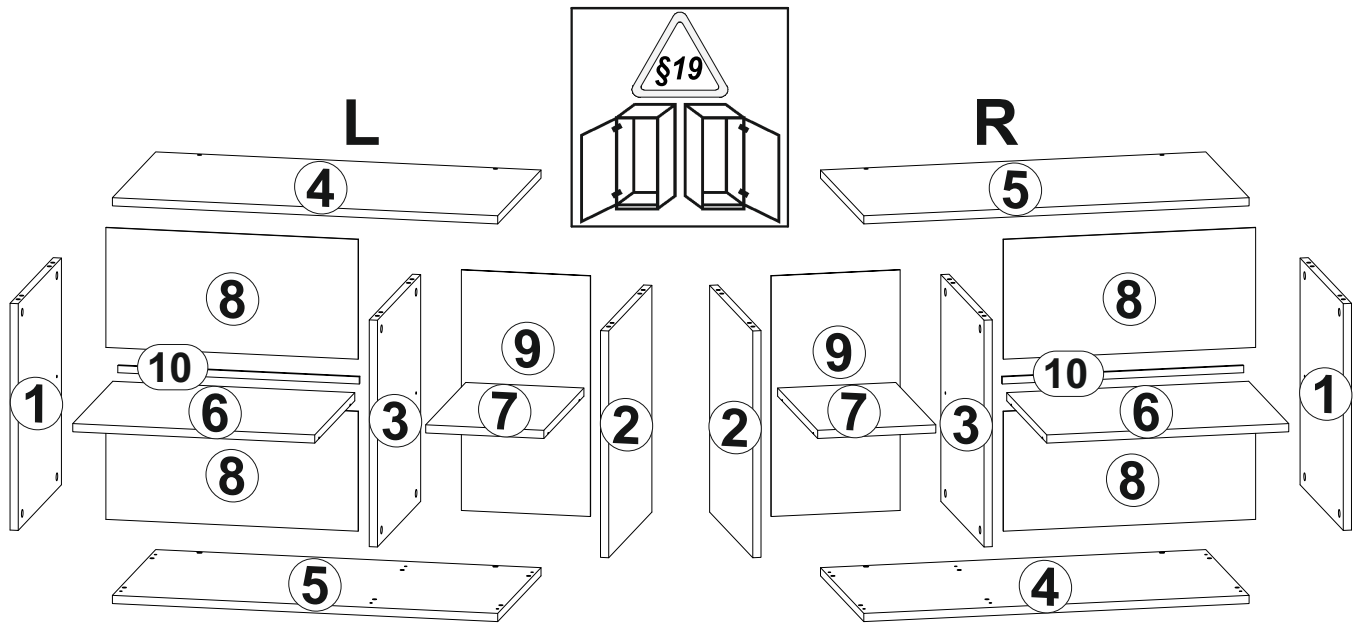

A	B	C		D	A	B	C		D
1	PR1-103	443	399	4/4	6	PR1-303	471	370	4/4
2	PR1-105	443	399	4/4	7	PR1-304	230	370	4/4
3	PR1-104	443	399	4/4	8	PR1-902	234	491	4/4
4	PR1-203	750	400	4/4	9	PR1-903	470	251	4/4
5	PR1-204	750	400	4/4	10	LH-470	470	14	4/4

## 1

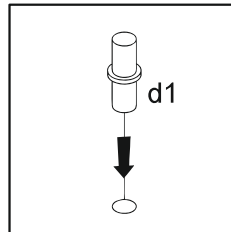
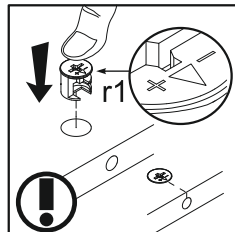
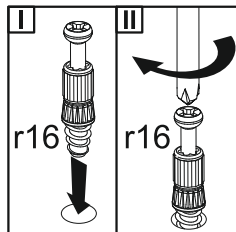
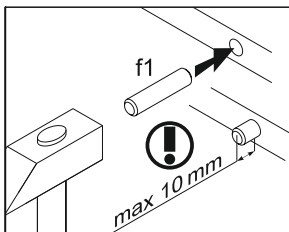
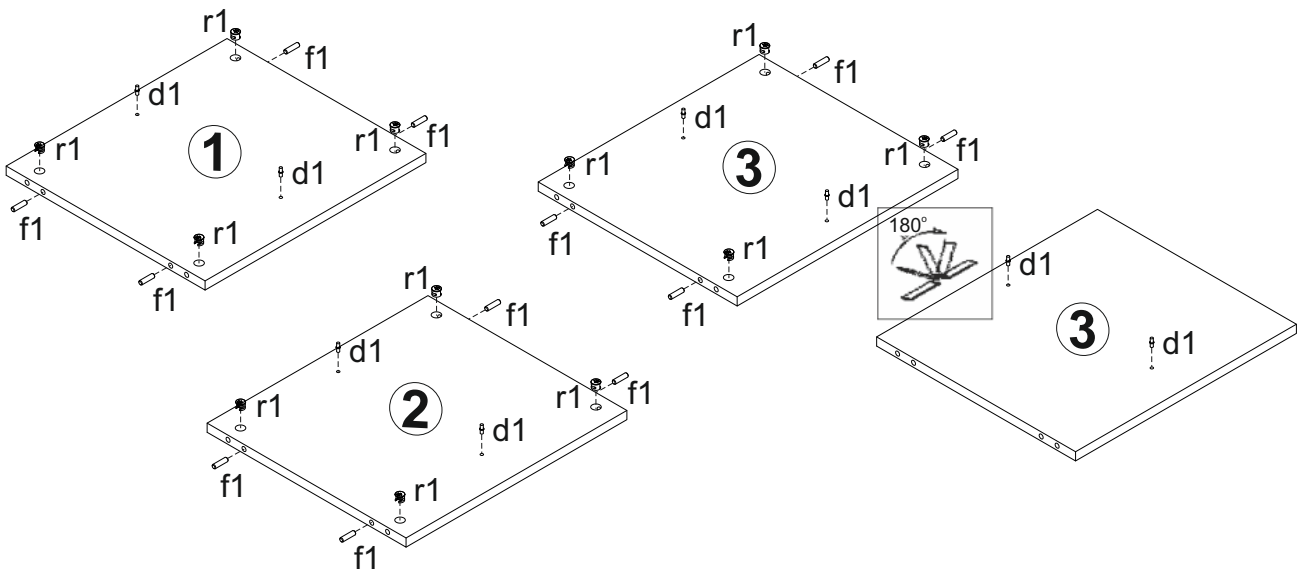

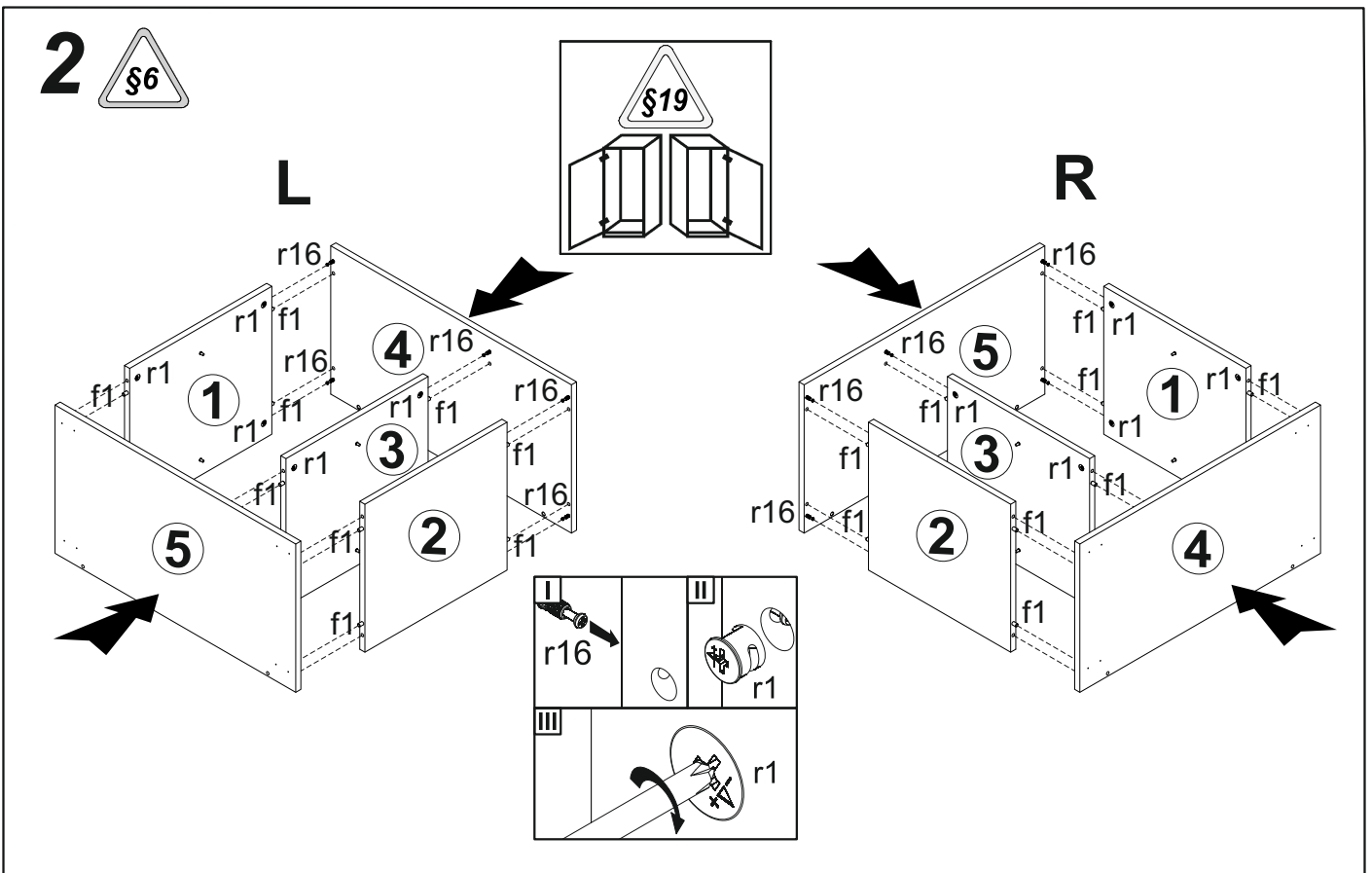
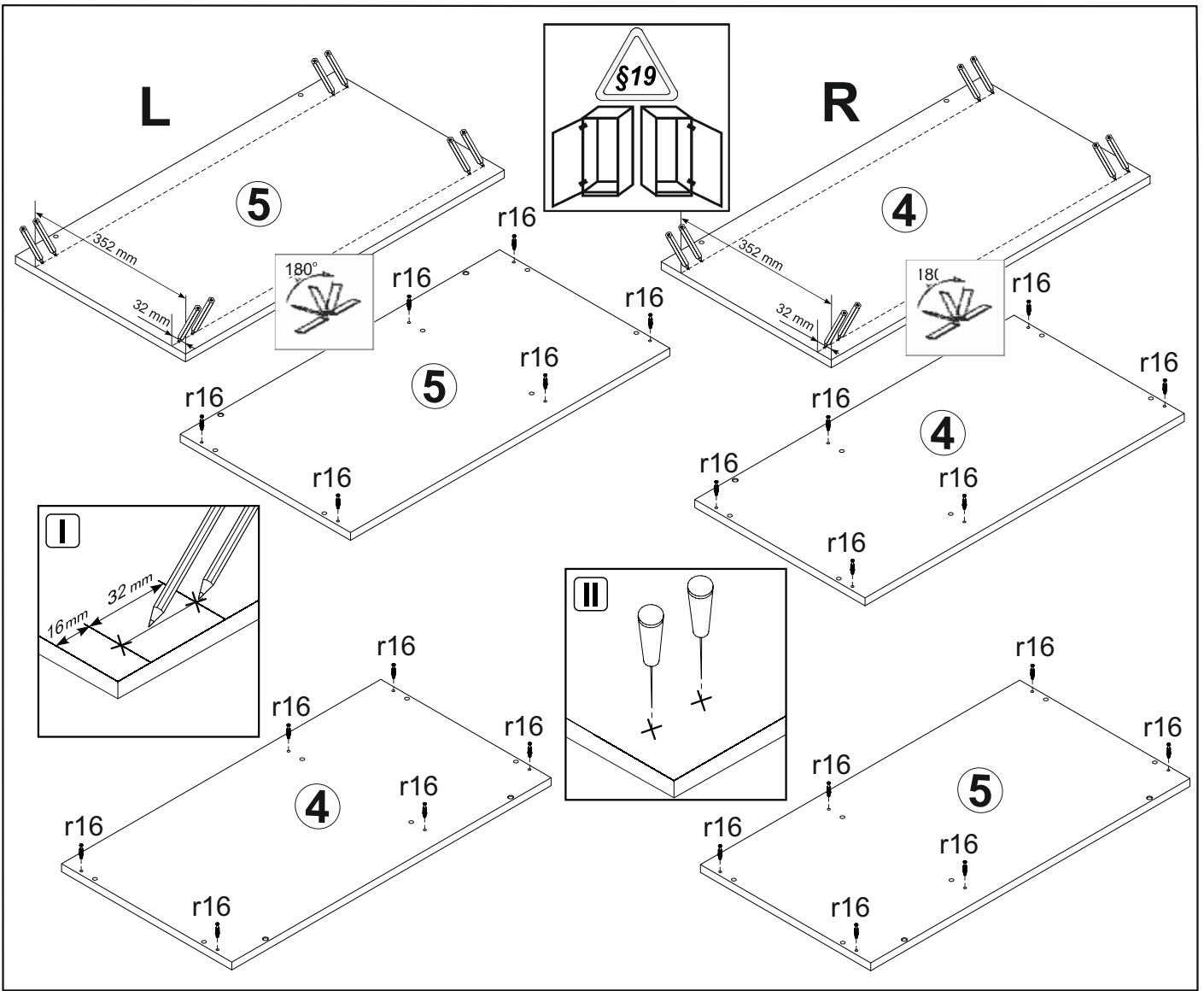

# 3

- 4x k55 60x60/25 mm
- 8x p6  $\phi 4 \times 35$  mm
- 24x l1
- 4x n108 20x13x3,5/1 mm
- 4x p55  $\phi 2,9 \times 16$  mm

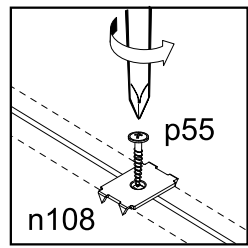
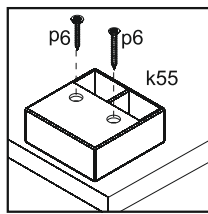
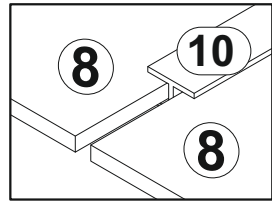
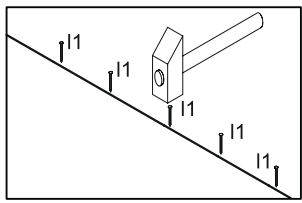
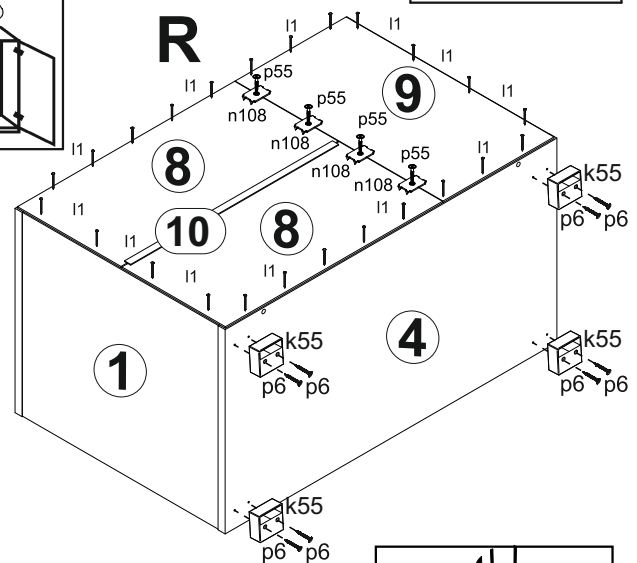
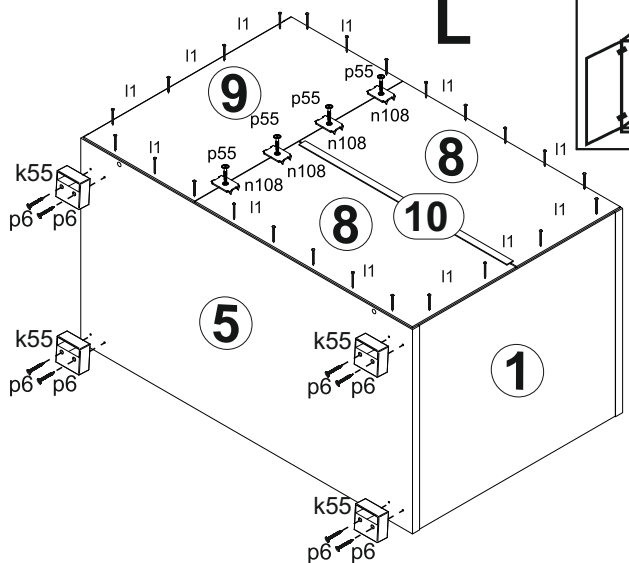
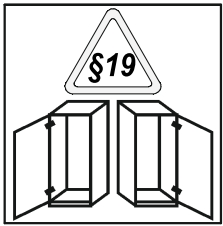
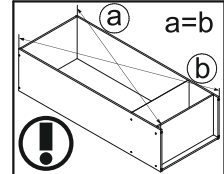

# 4

- 12x s2  $\phi 16$

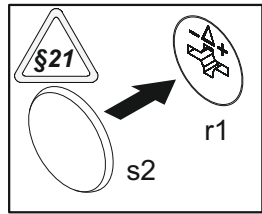
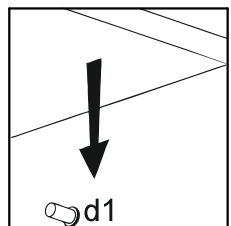
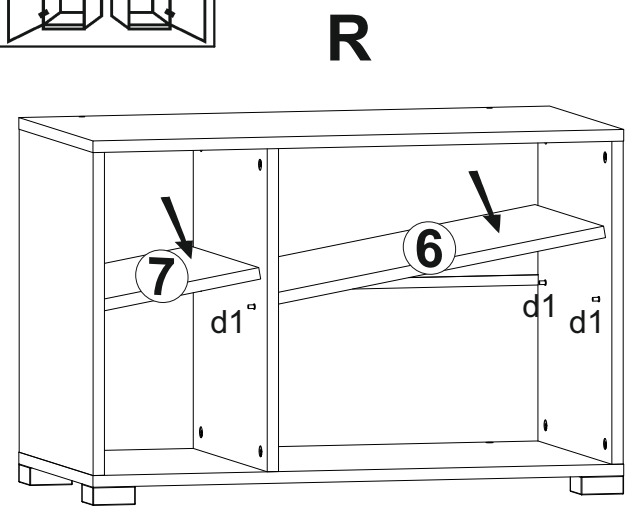
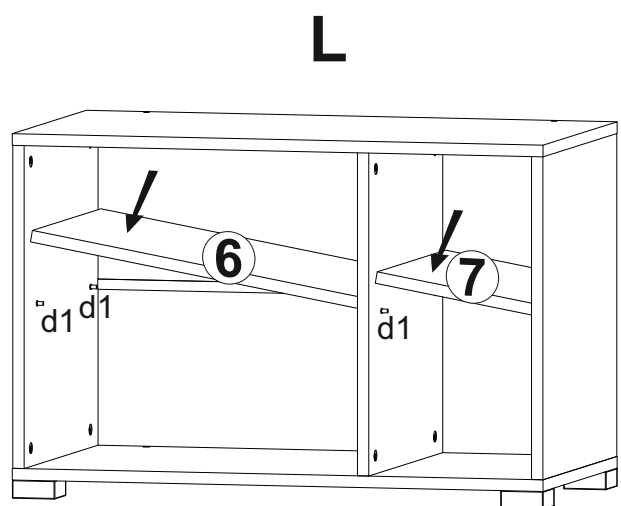
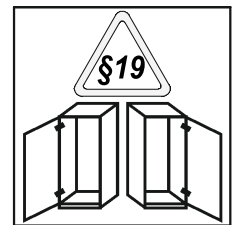

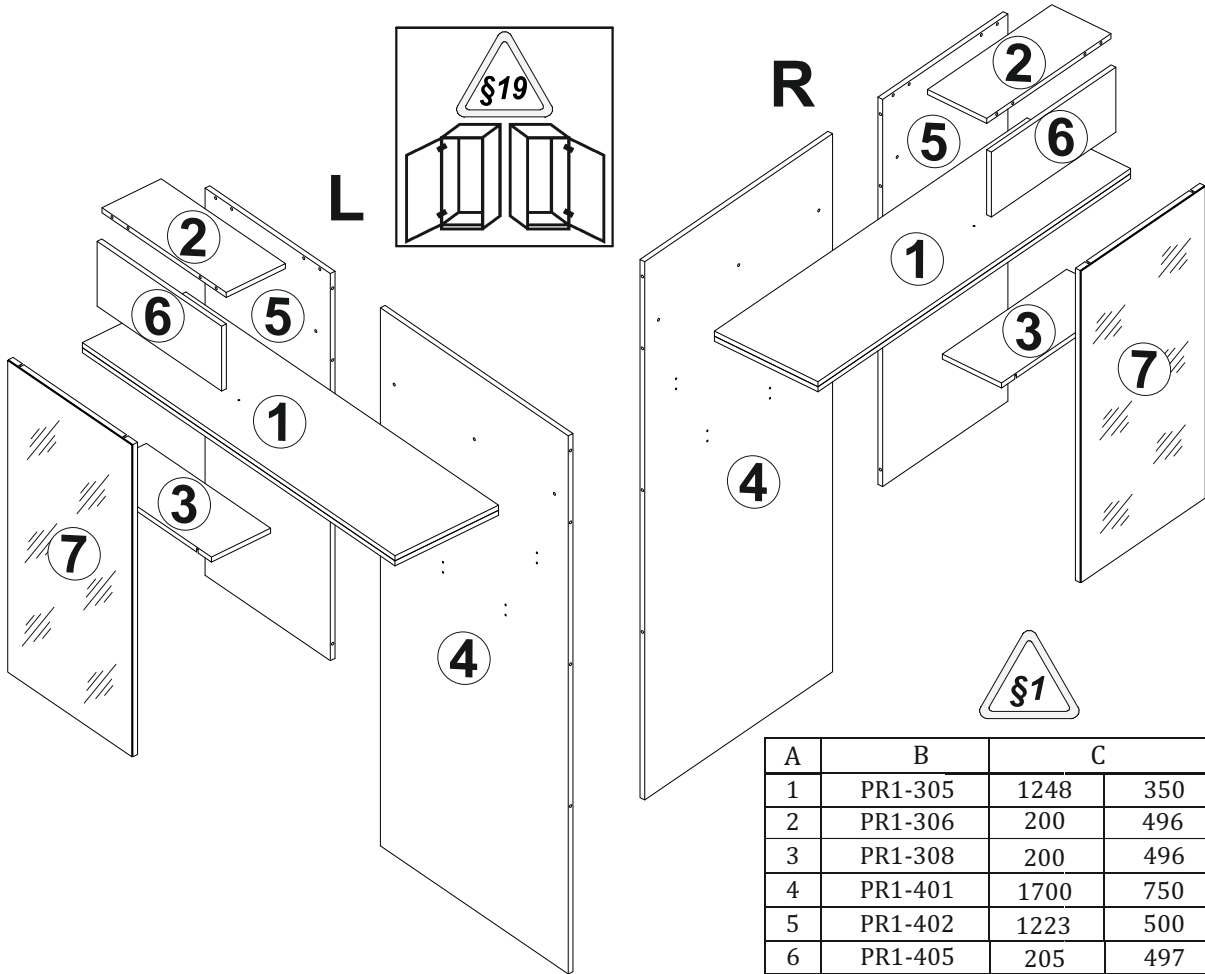

A	B	C	D	
1	PR1-305	1248	350	1/4
2	PR1-306	200	496	1/4
3	PR1-308	200	496	1/4
4	PR1-401	1700	750	1/4
5	PR1-402	1223	500	1/4
6	PR1-405	205	497	1/4
7	PR1-501	986	497	2/4

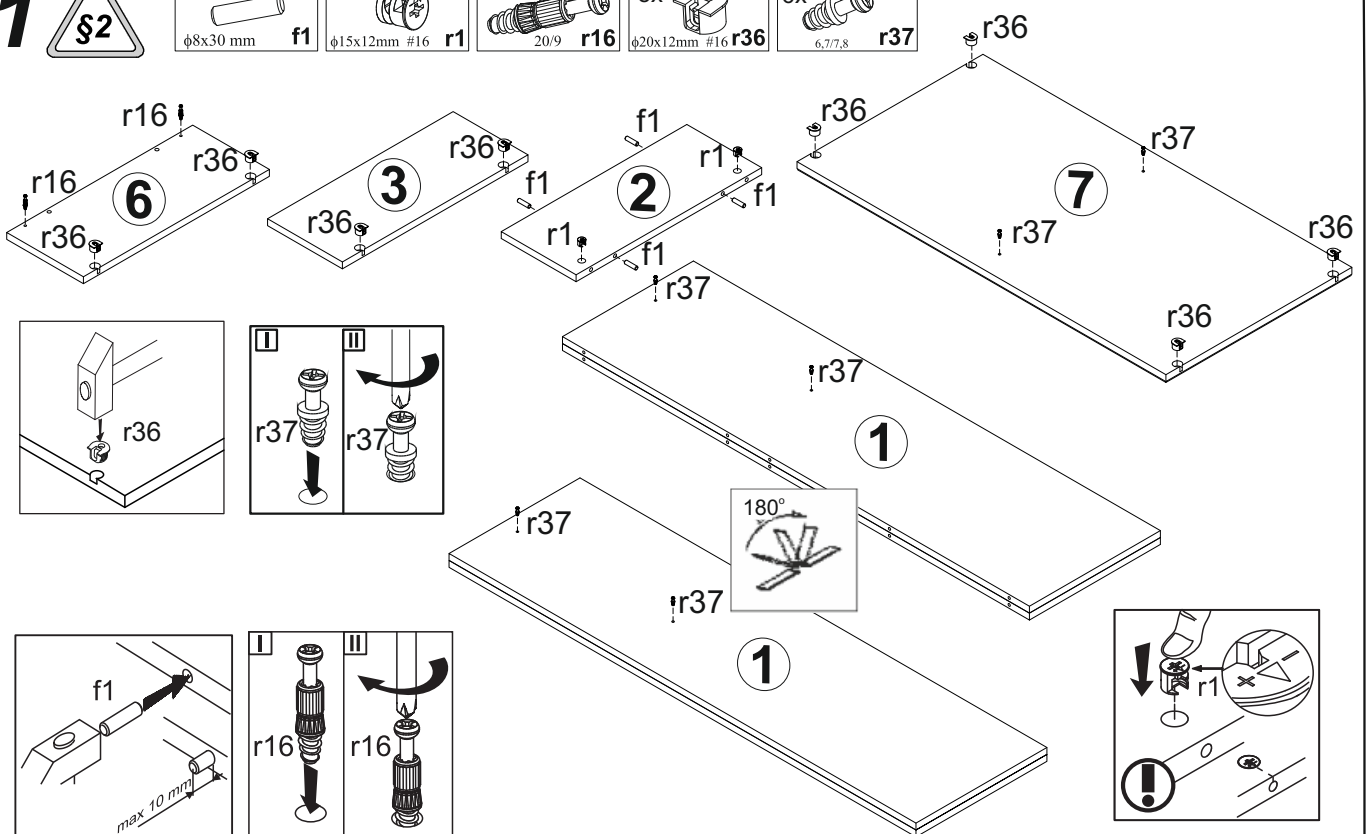
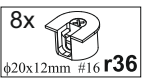
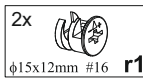
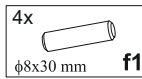



2

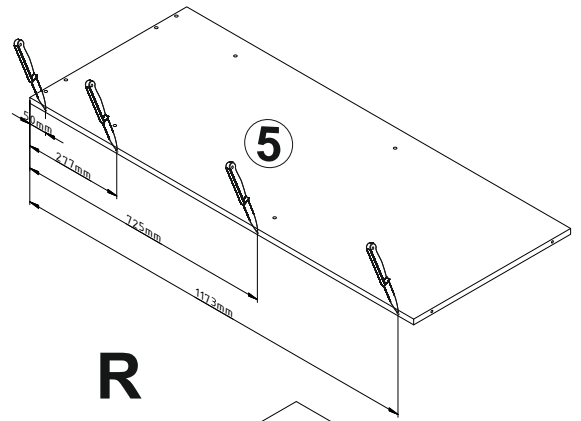
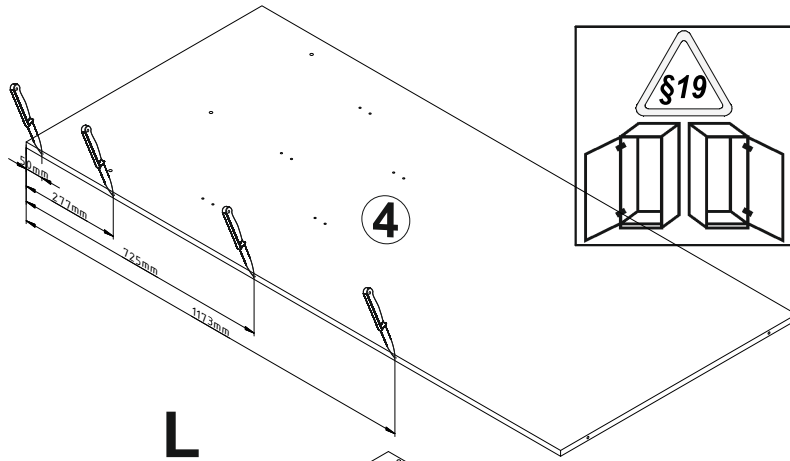
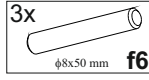
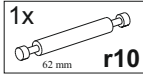
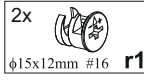

R

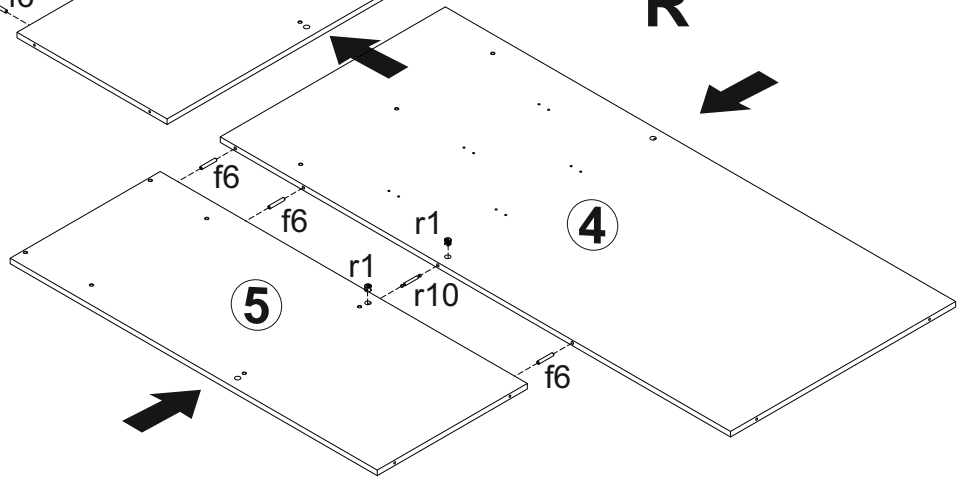
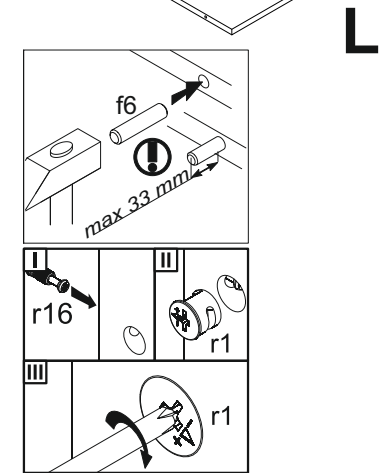
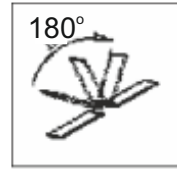
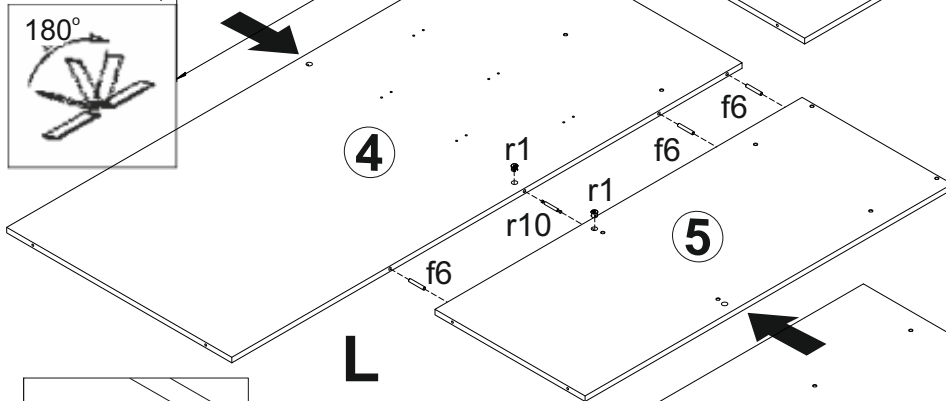
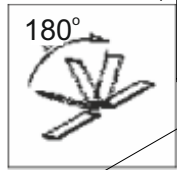
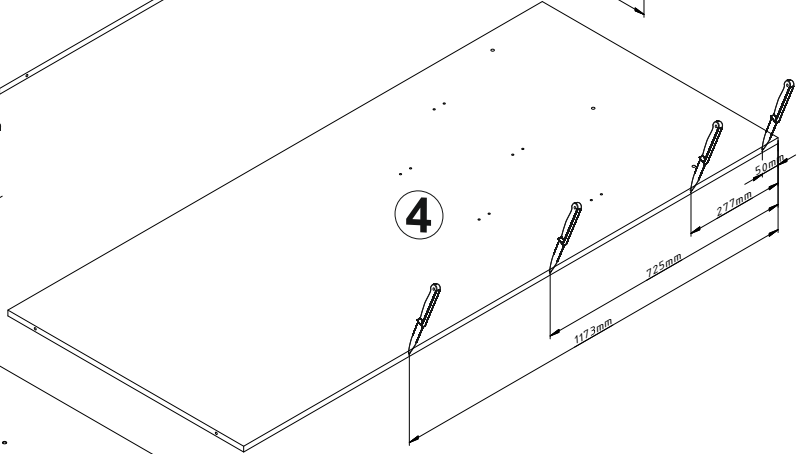
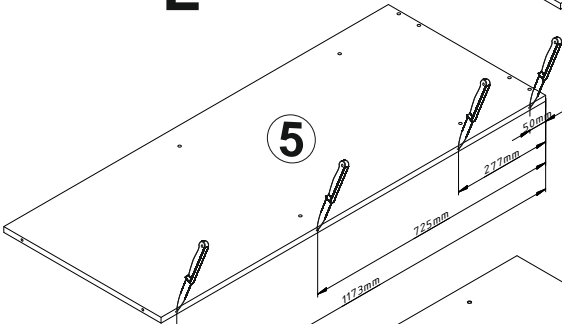

R

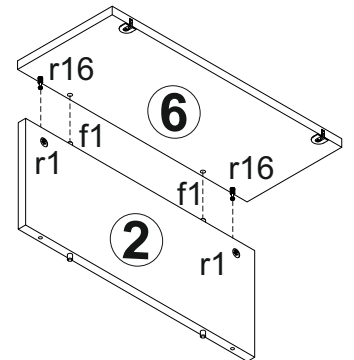
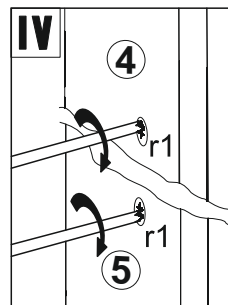
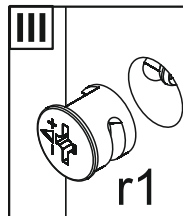
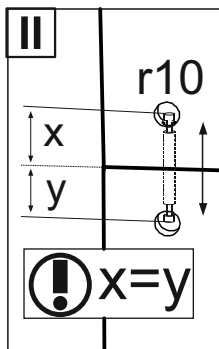
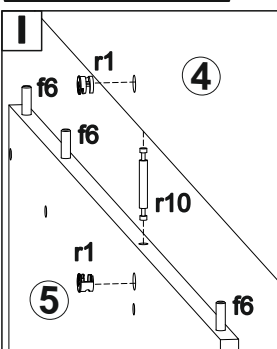
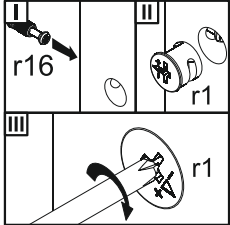
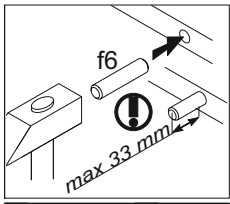

3

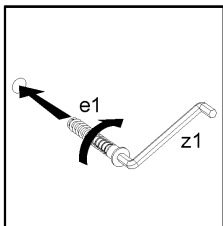
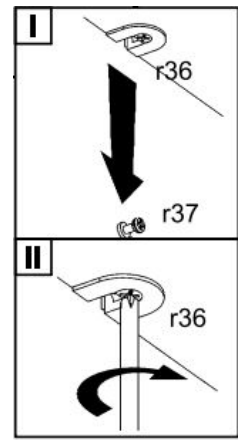
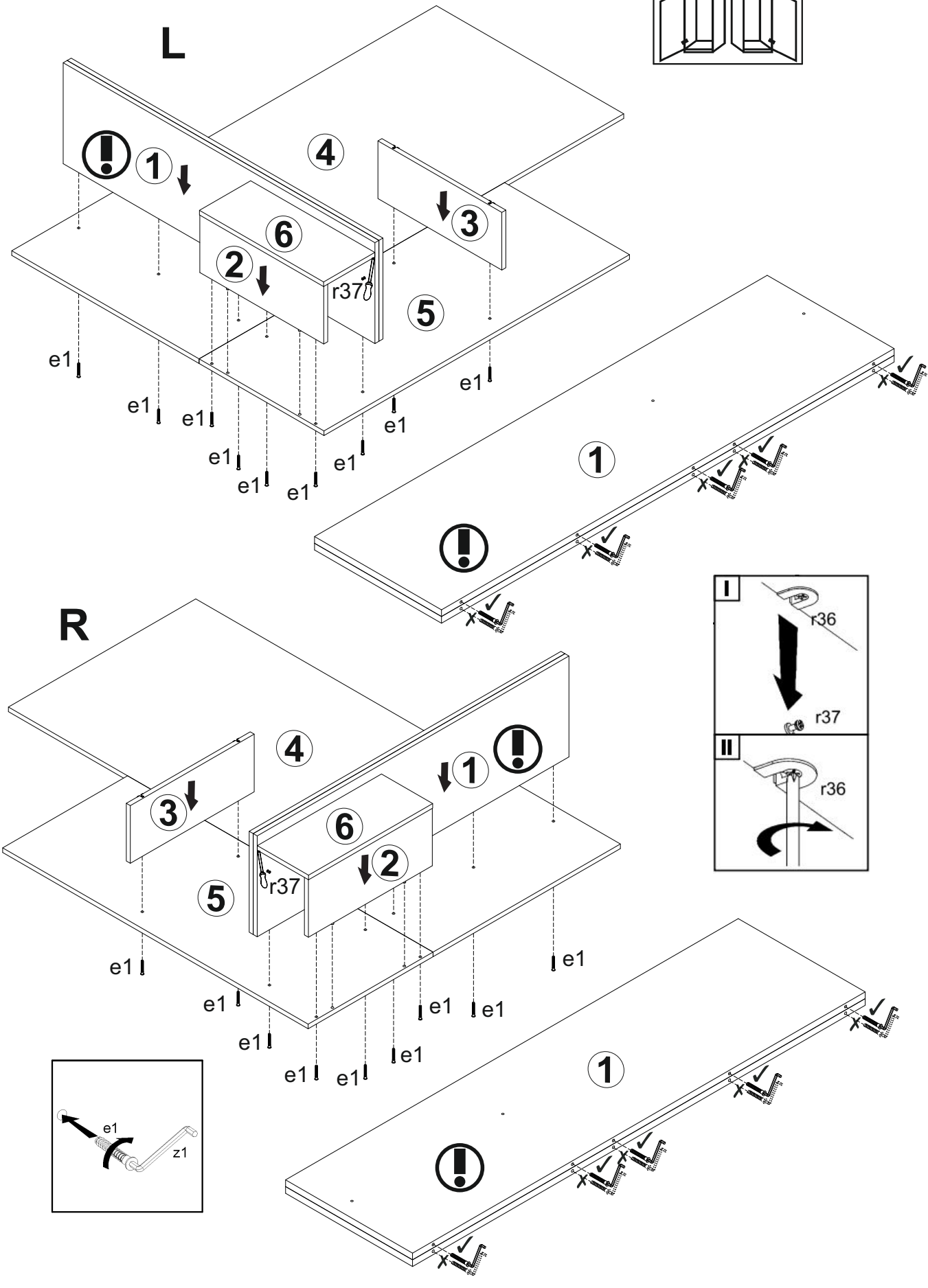
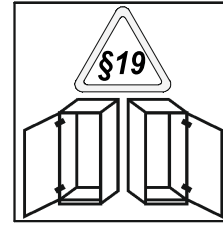
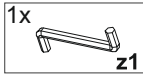
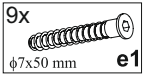

- 4**
- 4x  $\phi 7 \times 50$  mm e1
  - 1x z1
  - 4x M4x12 mm j45<sup>1</sup>
  - 2x j45<sup>2</sup>
  - 2x 6,7/7,8 r37
  - 2x  $\phi 16$  s2

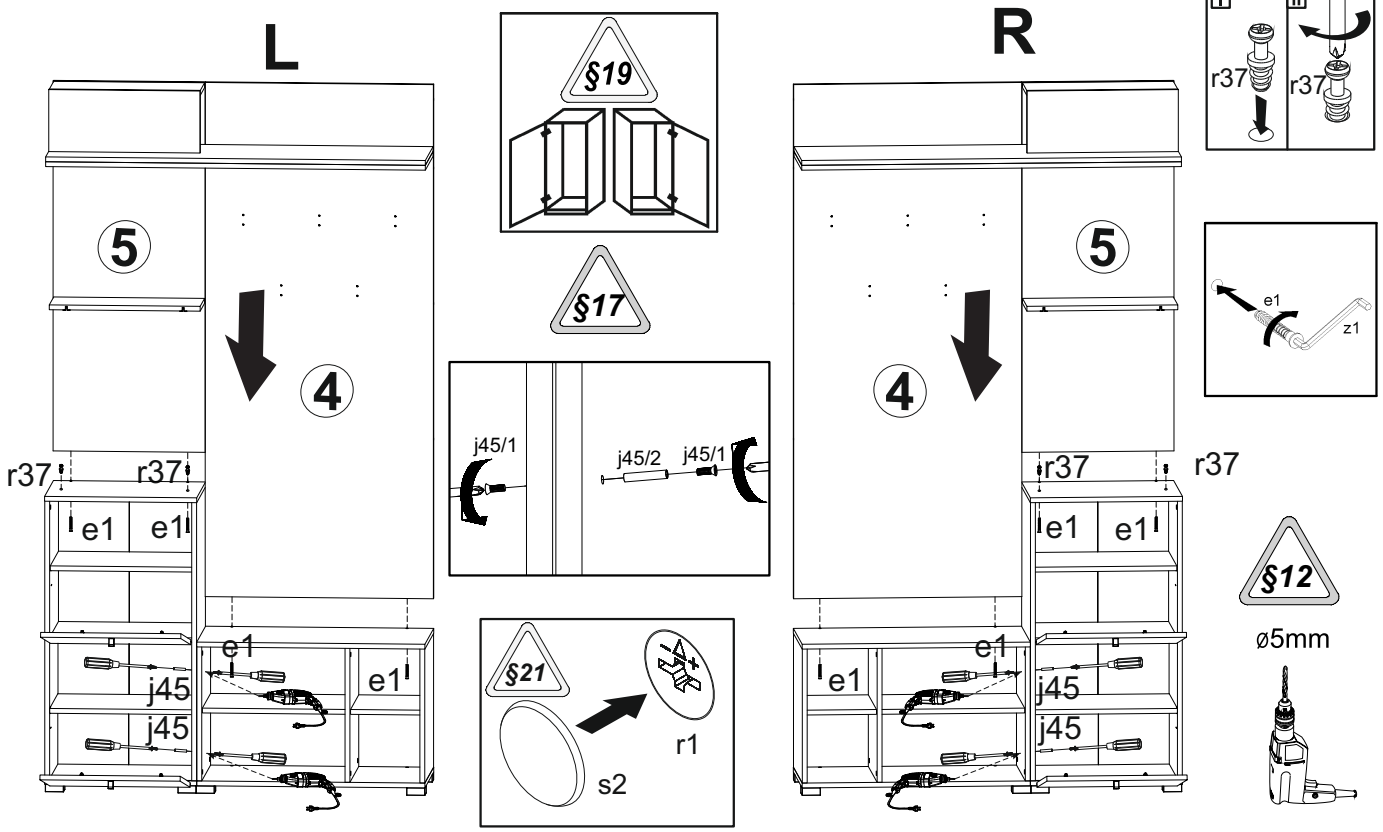

- 5**
- 5x 32 mm g500
  - 10x M4x22 mm j30
  - 1x 81x21 n14
  - 2x  $\phi 3,5 \times 13$  mm p5

