

A	B	C	D	A	B	C	D		
1	KR1-025	2029	749	4/5	14	KR1-108	407	460	3/5
2	KR1-026	2029	749	4/5	15	KR1-328	756	455	3/5
3	KR1-023	2029	749	5/5	16	KR1-329	624	460	3/5
4	KR1-027	618	175	3/5	17	KR1-503	400	120	3/5
5	KR1-110	2155	608	1/5	18	KR1-504	400	120	3/5
6	KR1-111	2155	608	1/5	19	KR1-516	567	120	3/5
7	KR1-107	1619	460	1/5	20	KR1-910	399	582	3/5
8	KR1-109	1619	460	1/5	21	KR1-908	1634	770	5/5
9	KR1-326	2168	566	2/5	22	KR1-909	1634	640	5/5
10	KR1-325	2168	583	2/5	23	KR1-917	422	1091	5/5
11	KR1-327	2168	460	2/5	24	DR-619	619		1/5
12	KR1-411	2168	80	2/5	25	DR-751	751		1/5
13	KR1-412	2168	80	2/5	26		2167		2/5

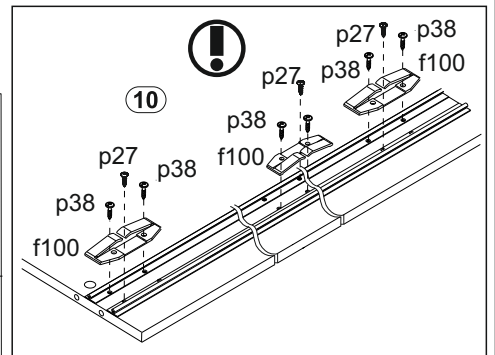

47x φ8x30 mm f1	44x r16	44x φ15x12mm #16 r1	12x φ5x17 mm d1	8x k1	4x φ3,5x13 mm p1	3x Stoper f100	4x φ3,5x16 mm p25
6x l1	4x n1	1x n26\1	36x φ16 s2	7x φ3,5x16 mm p38	24x l2	12x φ6x13 mm e3	49x φ3,5x13 mm p27
6x n181	6x n182	12x φ4x13 mm p28	12x φ5x12 mm e41	6x φ3,5x25 mm p42	8x φ5x50 mm e32	8x φ3x12 mm p54	2x 276 mm c806\1
2x 400 mm w5 ^{CL}	2x 400 mm w5 ^{CR}	2x 400 mm w5 ^{DL}	2x 400 mm w5 ^{DR}	2x 383 mm t14	3x φ8x1,8mm o21	22x 20x13x3,5\1 n108	22x φ2,9x16 mm p55

1

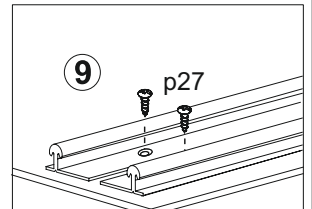
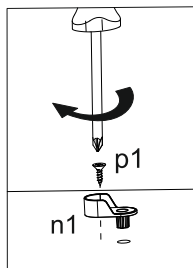
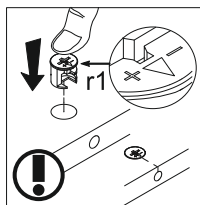
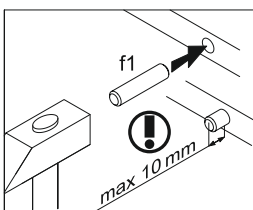
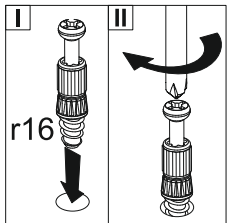
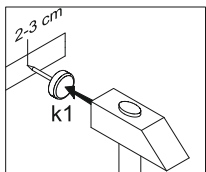
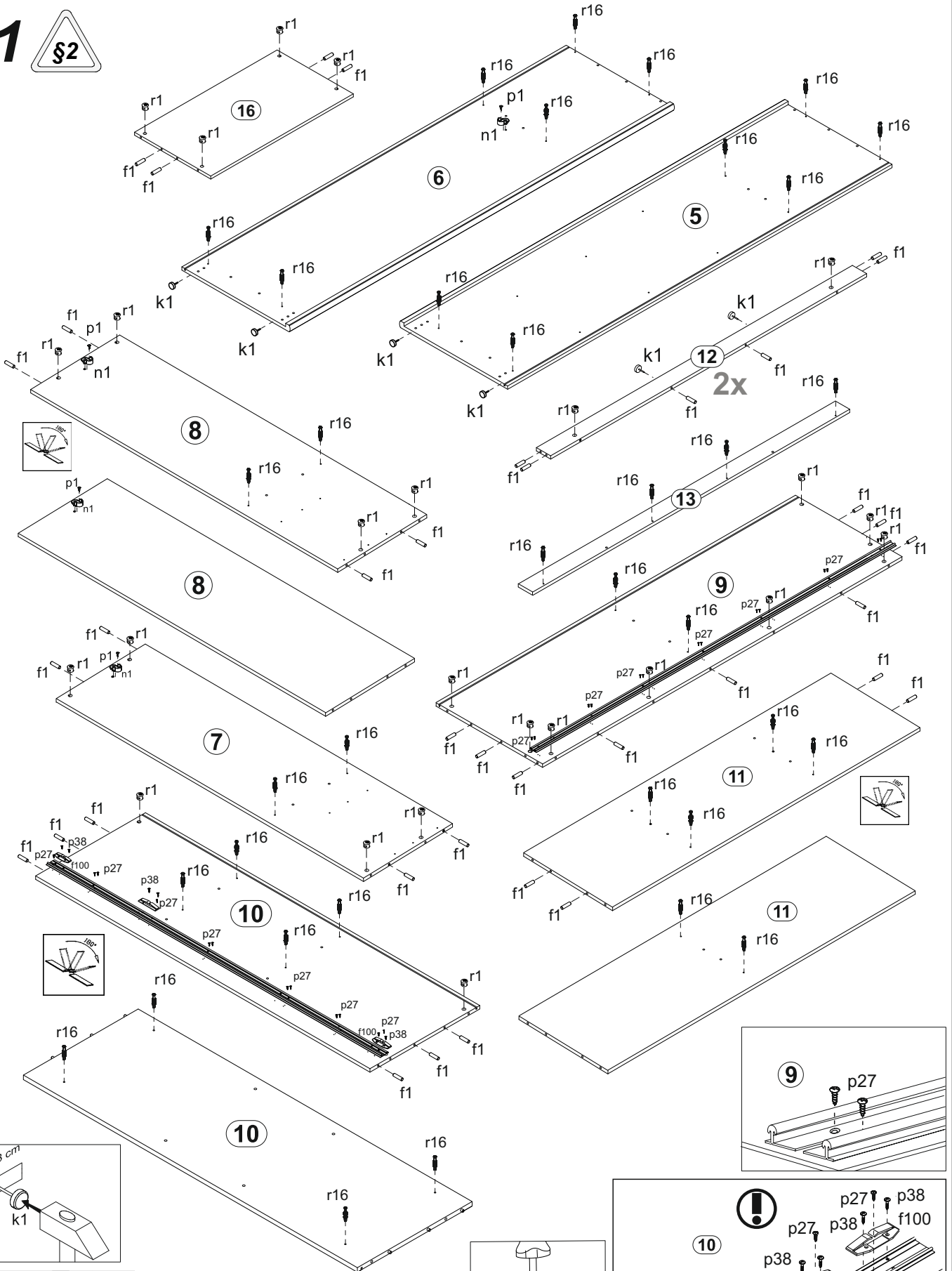

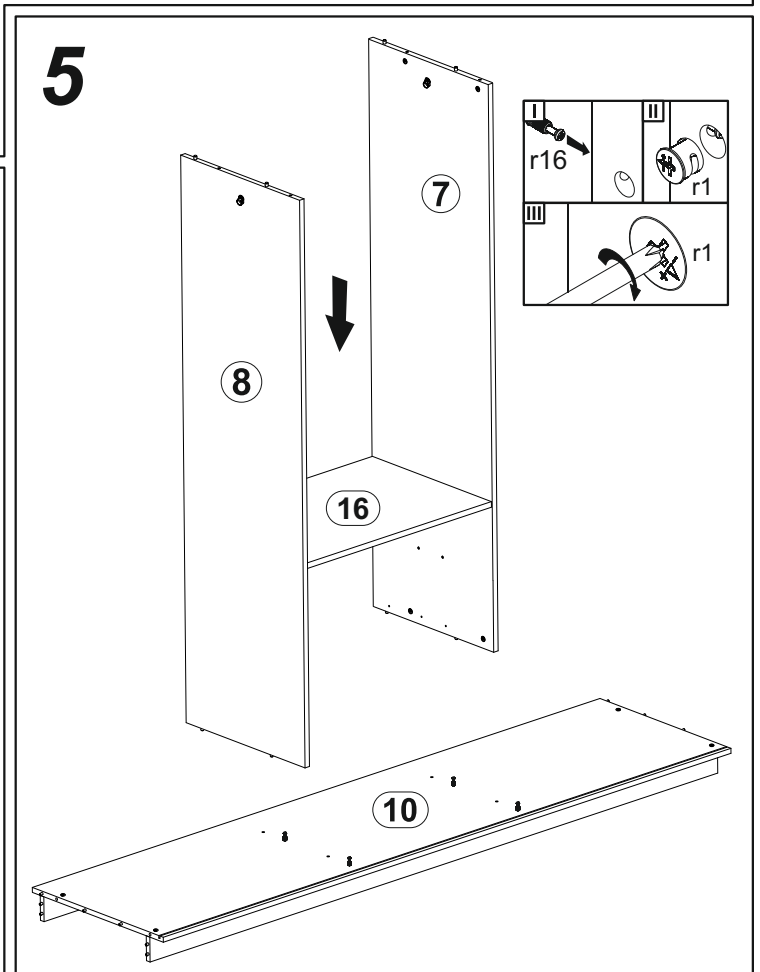
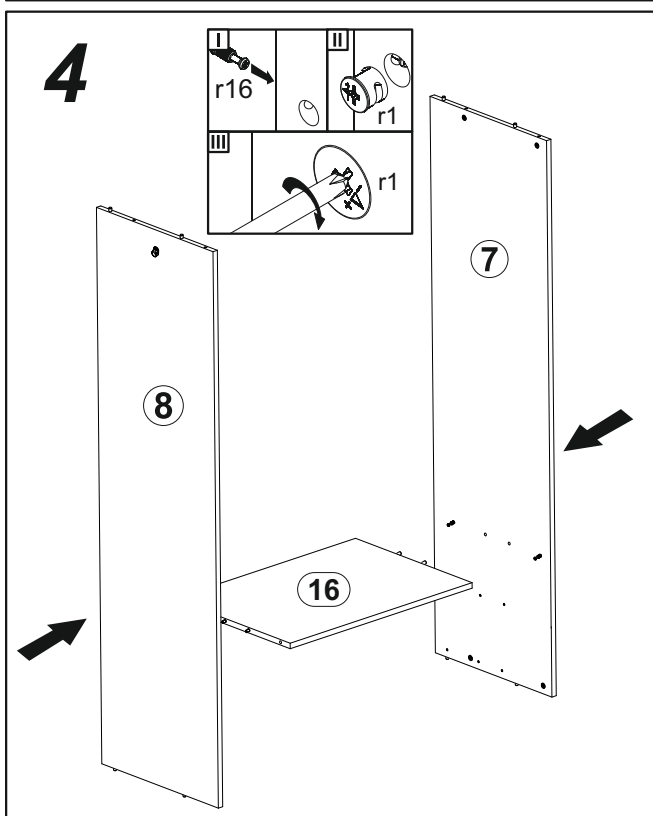
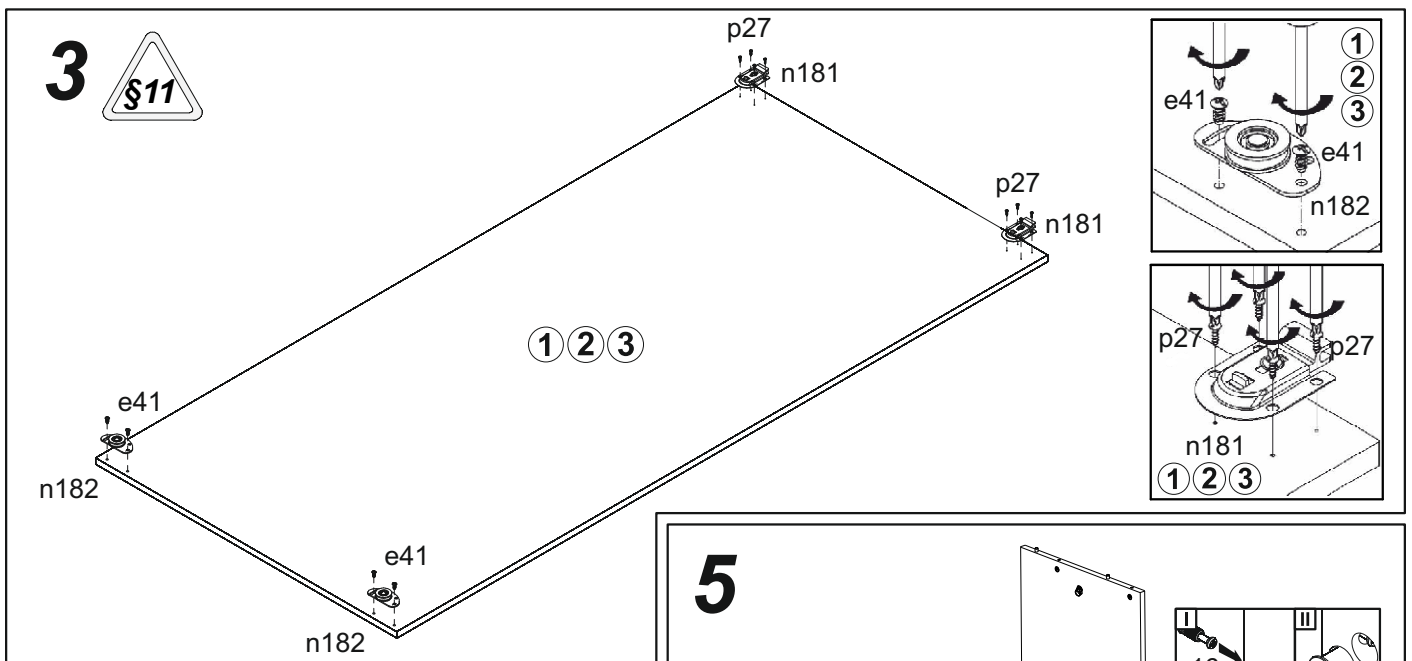
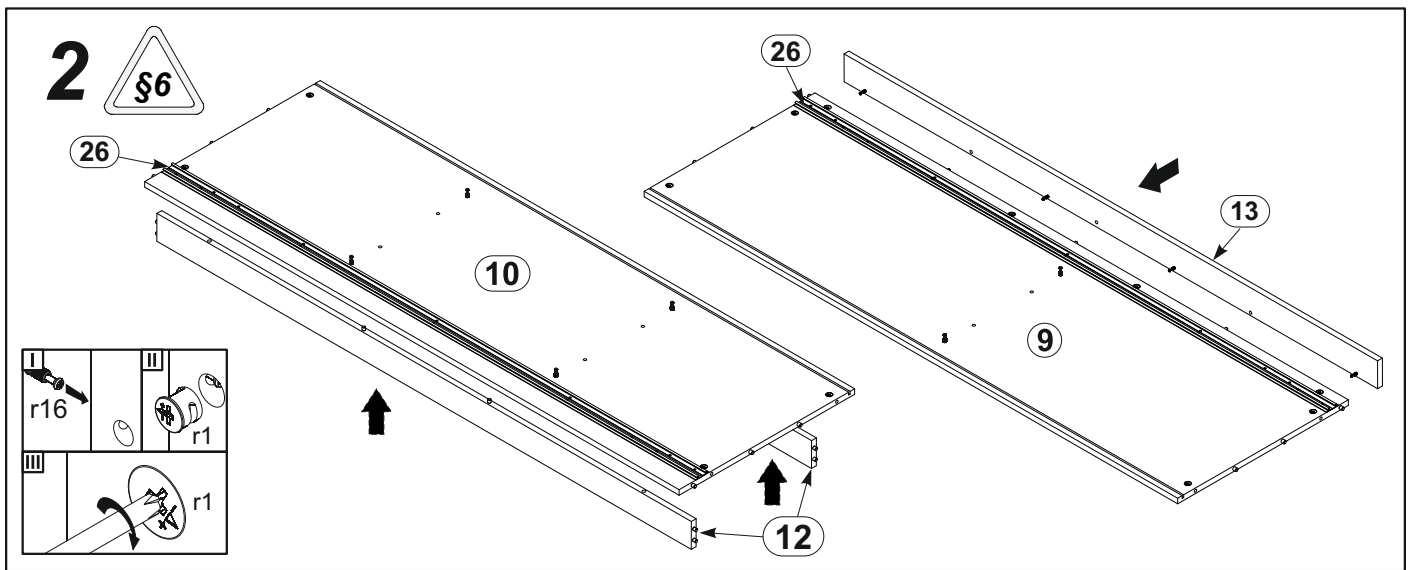

6

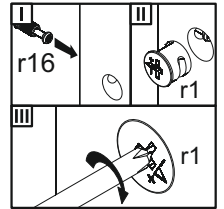
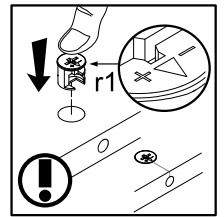
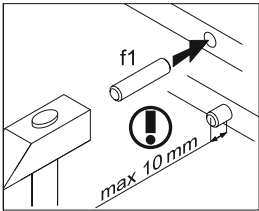
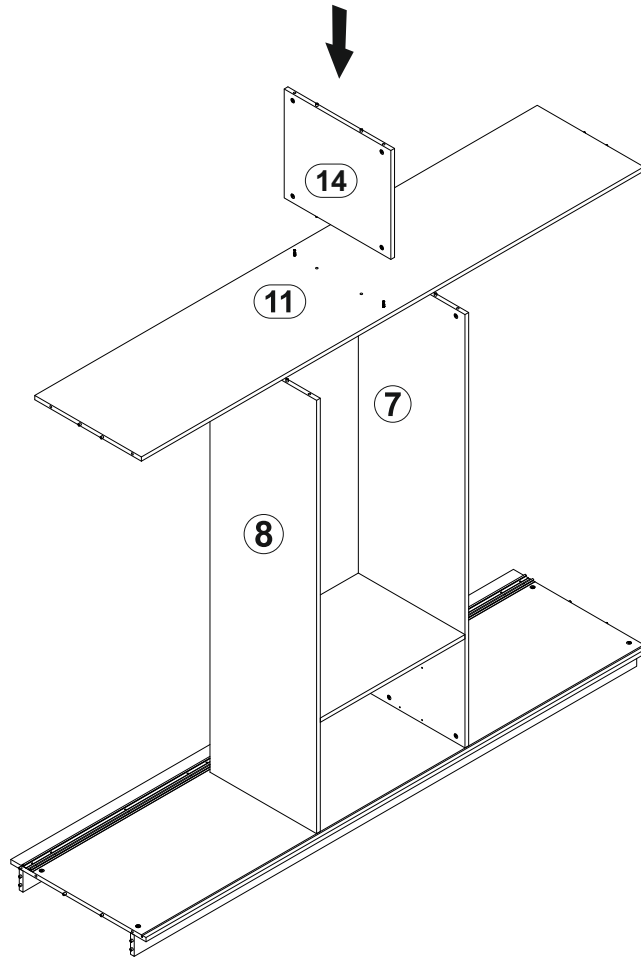
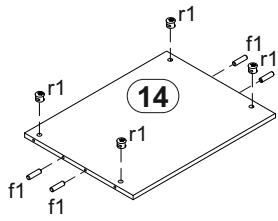

7

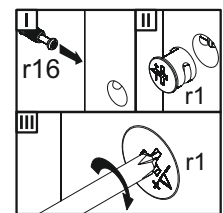
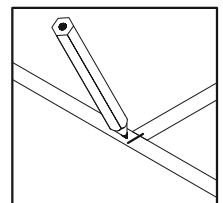
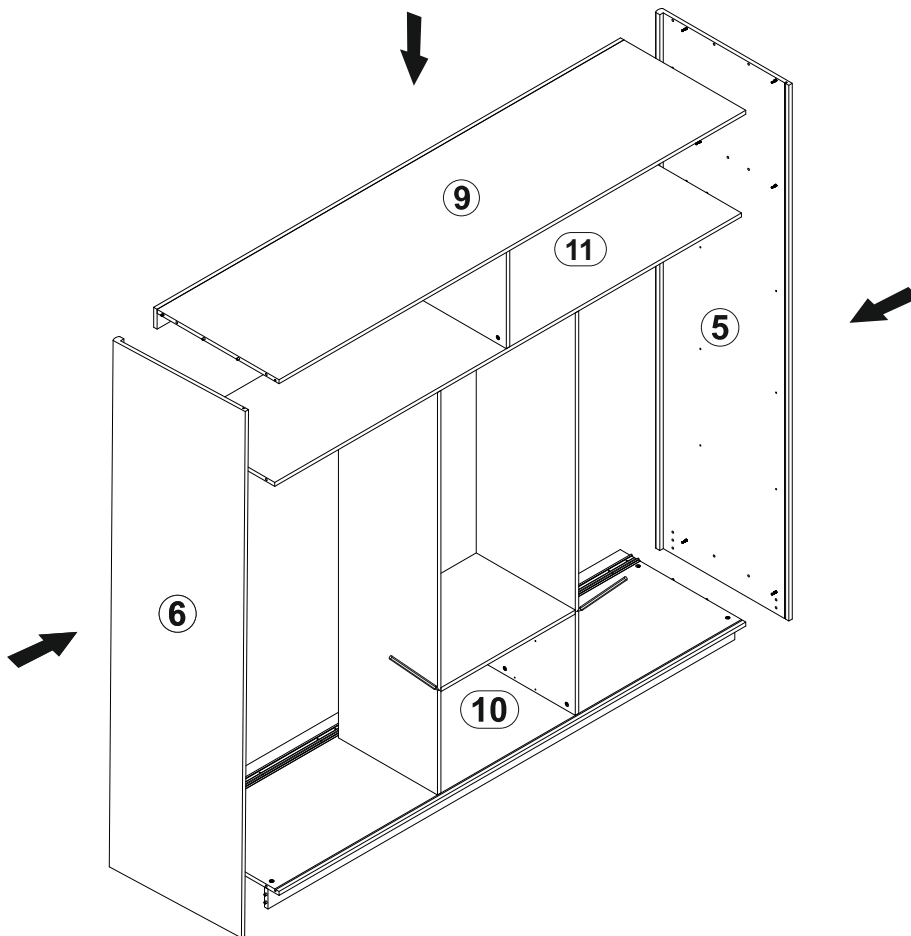

8

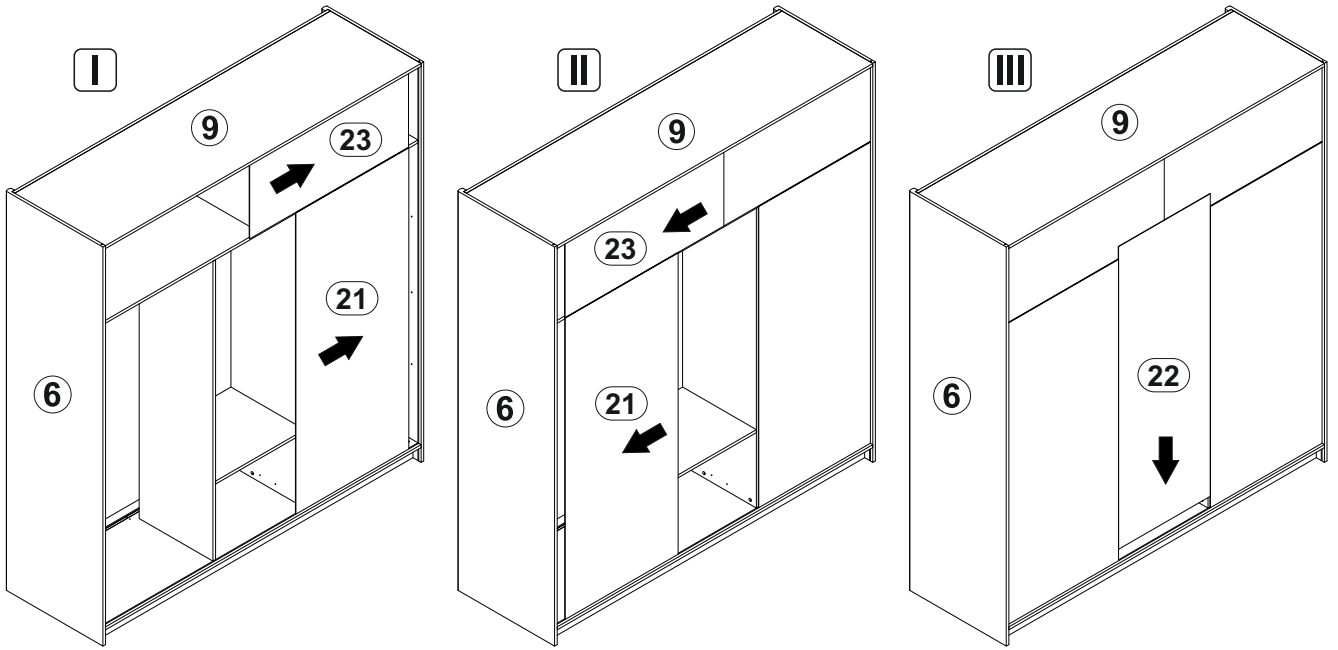

9

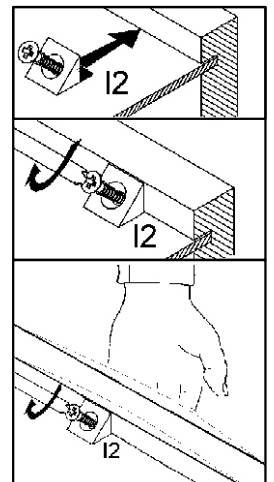
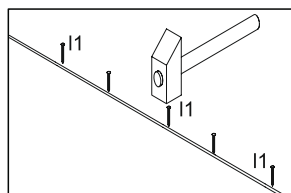
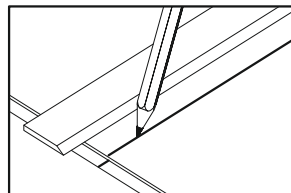
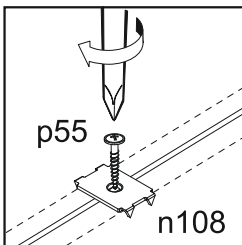
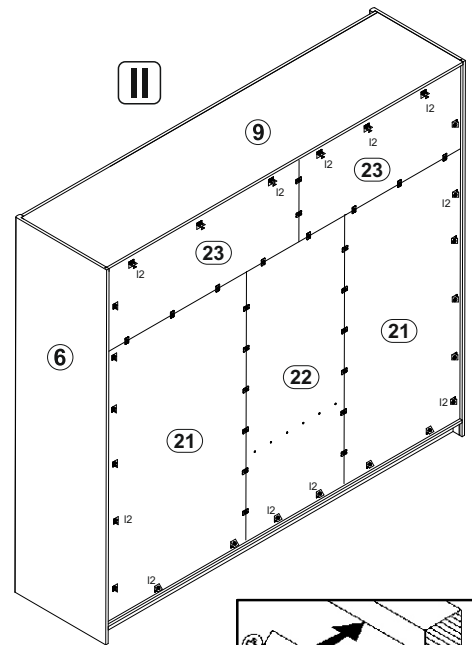
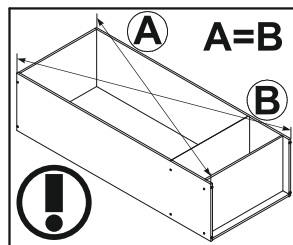
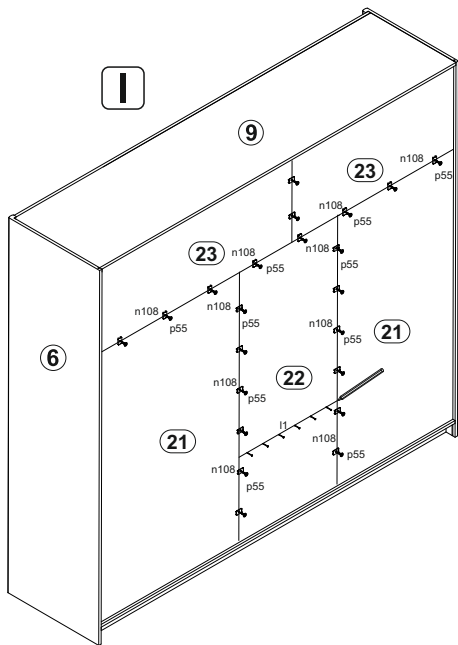

10

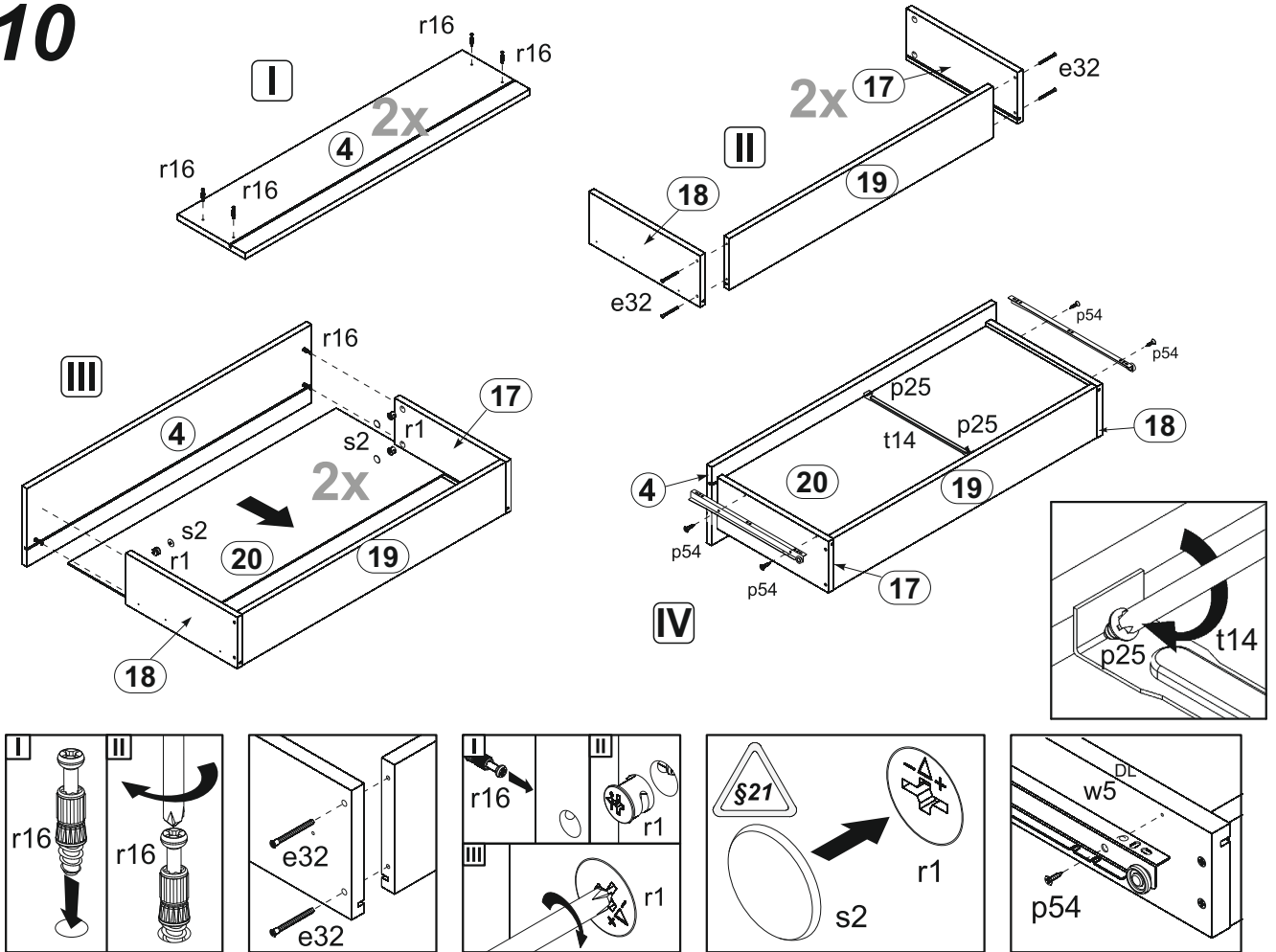

11

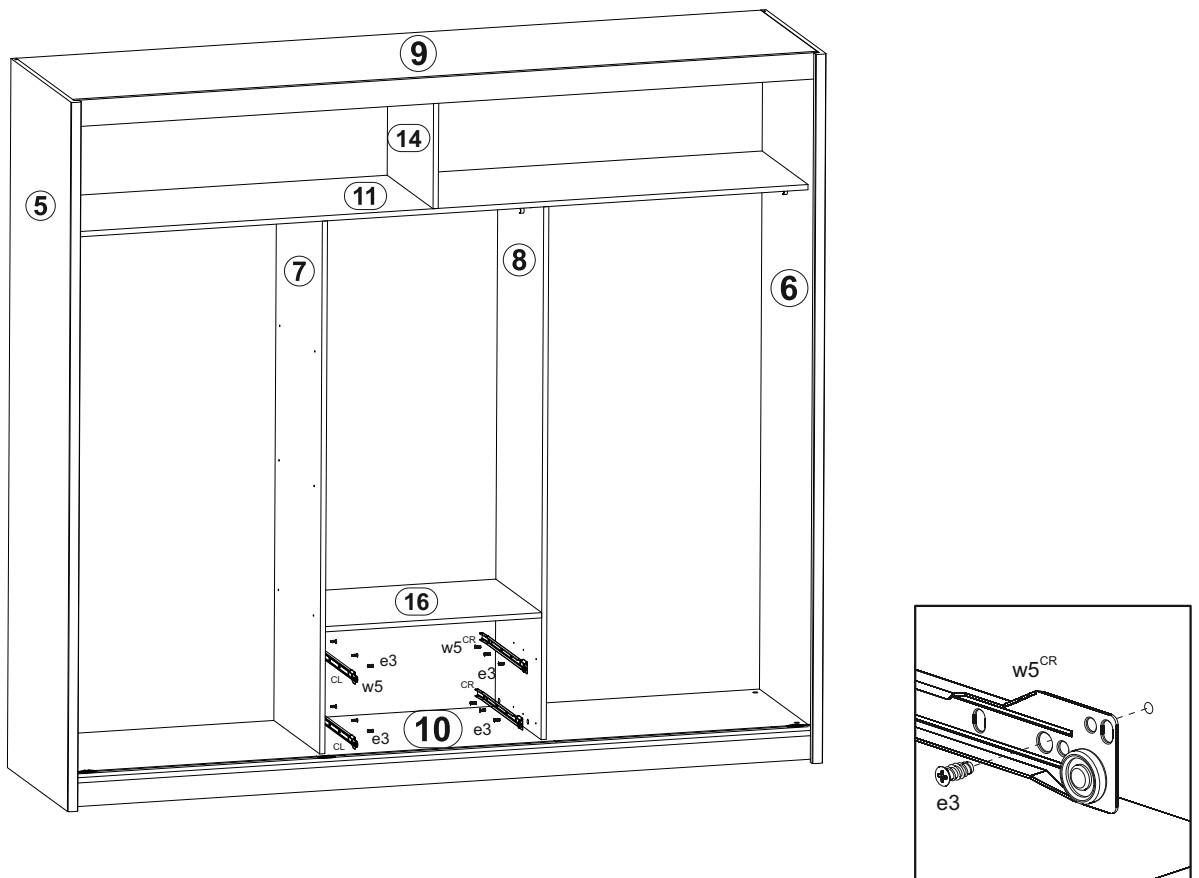

12

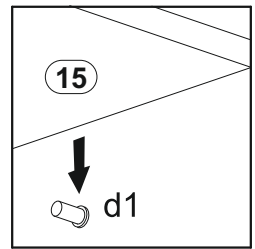
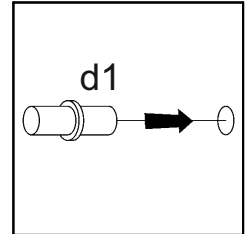
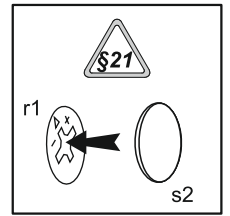
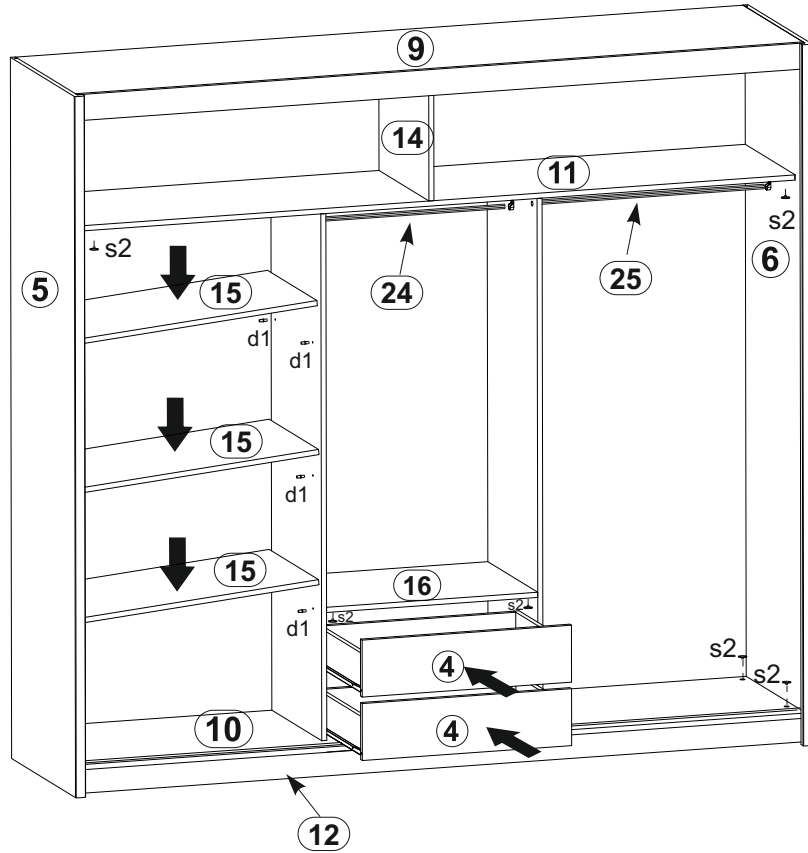
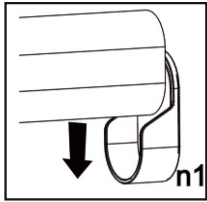

13

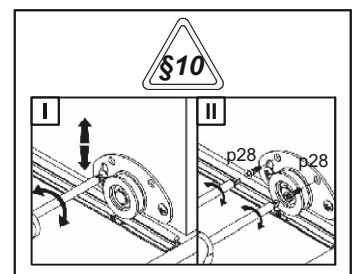
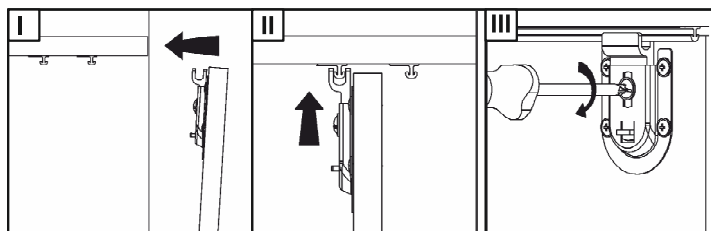
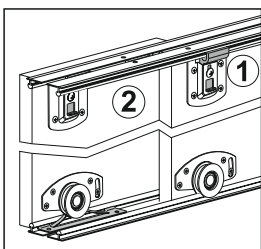
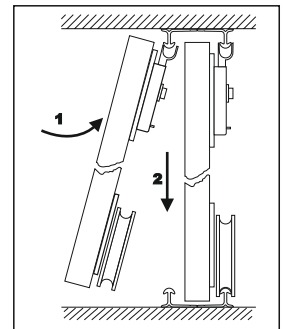
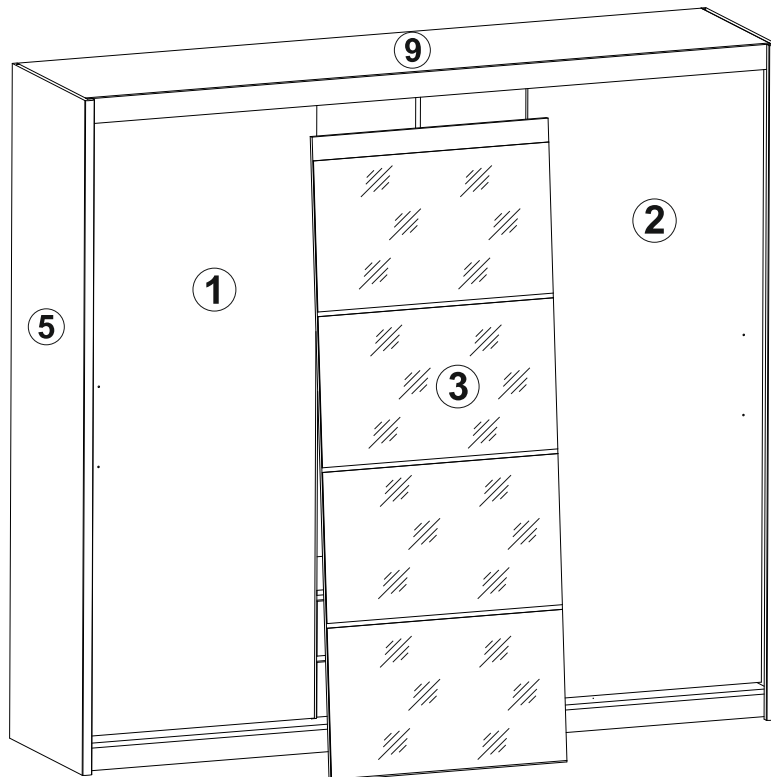

14

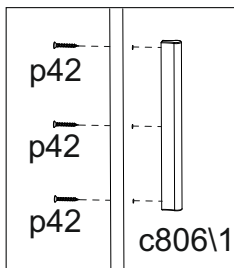
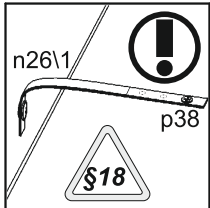
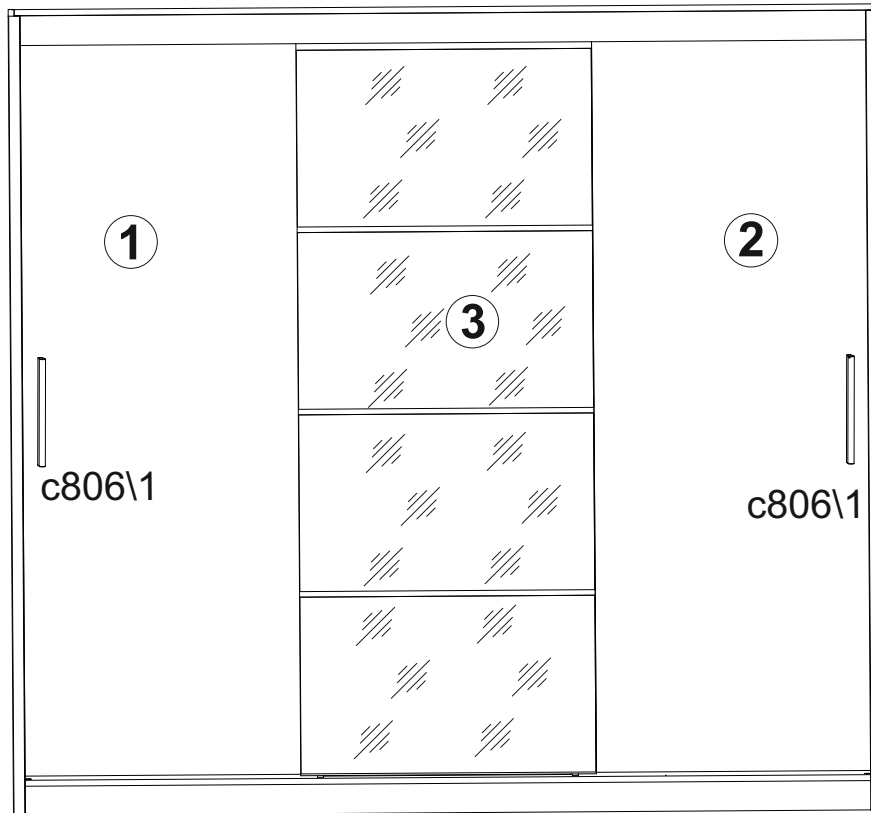

15

